

Norris Reservoir Land Management Plan - Summary of Allocation Changes

Land use allocation changes on Norris Reservoir that have occurred since the 2001 Norris Reservoir Land Management Plan (RLMP) was completed are summarized below:

Parcel & Tract No.	2001 Norris RLMP		Allocation Change Description ²	Justification ³
	Allocation ¹	Acres		
Parcel 6 (XNR-6PT)	Zone 2	903.74	<ul style="list-style-type: none"> 91.64 acres changed to Zone 6 (new Parcel 6a) 7.38 acres of underwater area removed from Parcel 6 Parcel 6 is now 804.72 acres and remains Zone 2 	Administrative and Mapping Errors
Parcel 7 (XNR-7PT)	Zone 4	456.49	<ul style="list-style-type: none"> 423.89 acres now Zone 1 Parcel 7 is now 32.6 acres and remains Zone 4 	Administrative Error
Parcel 10	Zone 3	73.81	<ul style="list-style-type: none"> 1.43 acres changed to Zone 6 (new Parcel 10a) Parcel 10 is now 72.38 acres and remains Zone 3 	Administrative Error
Parcel 21 (XNR-21PT)	Zone 6	3.11	<ul style="list-style-type: none"> 0.12 acre changed to Zone 7 (new Parcel 21a) Parcel 21 is now 2.99 acres and remains Zone 6 	Implement Shoreline Management Policy
Parcel 66 (XNR-66PT)	Zone 6	6.97	<ul style="list-style-type: none"> 1.17 acres changed to Zone 7 (new Parcel 66a) Parcel 66 is now 5.8 acres and remains Zone 6 	Administrative Error
Parcel 80 (XNR-80PT)	Zone 6	8.23	<ul style="list-style-type: none"> 2.85 acres changed to Zone 7 (new Parcel 80a) Parcel 80 is now 5.37 acres and remains Zone 6 	Implement Shoreline Management Policy
Parcel 80 (XNR-80PT)	Zone 6	5.37	<ul style="list-style-type: none"> 1.03 acres changed to Zone 7 (new Parcel 80b) Parcel 80 is now 4.34 acres and remains Zone 6 	Implement Shoreline Management Policy
Parcel 108 (XNR-108PT)	Zone 7	8.75	<ul style="list-style-type: none"> 0.45 acres changed to Zone 6 (new Parcel 108a) Parcel 108 is now 8.3 acres and remains Zone 7 	Administrative Error
Parcel 121 (XNR-121PT)	Zone 4	2,147.03	<ul style="list-style-type: none"> 7.23 acres changed to Zone 7 (new Parcel 121a) Parcel 121 is now 2,139.80 acres and remains Zone 4 	Administrative Error
Parcel 159 (XNR-159PT)	Zone 6	25.39	<ul style="list-style-type: none"> 0.16 acres changed to Zone 7 (new Parcel 159a) Parcel 159 is now 25.23 acres and remains Zone 6 	Administrative Error
Parcel 160 (XNR-160PT)	Zone 4	5.64	<ul style="list-style-type: none"> Entire parcel (5.64 acres) changed to Zone 7 Parcel 160 remains 5.64 acres but is now Zone 7 	Administrative Error
Parcel 180 (XNR-180PT)	Zone 3	9.8	<ul style="list-style-type: none"> 2.89 acres changed to Zone 7 (new Parcel 180aPT) Parcel 180 is now 6.91 acres and remains Zone 3 	Administrative Error

Parcel 194 (XNR-194PT)	Zone 4	282.84	<ul style="list-style-type: none"> 3.0 acres changed to Zone 6 (new Parcel 194a) Parcel 194 is now 279.84 acres and remains Zone 4 	Administrative Error
Parcel 209 (XNR-209PT)	Zone 6	65.38	<ul style="list-style-type: none"> 7.00 acres changed to Zone 7 (new Parcel 209a) Parcel 209 is 58.38 acres and remains Zone 6 	Implement Shoreline Management Policy
Parcel 272 (XNR-272PT)	Zone 4	13.48	<ul style="list-style-type: none"> 10.04 acres changed to Zone 7 (new Parcel 272a) Parcel 272 is now 3.44 acres and remains Zone 4 	Administrative Error
Parcel 310 (XNR-310PT)	Zone 6	24.15	<ul style="list-style-type: none"> 1.03 acres changed to Zone 7 (new Parcel 310c) Parcel 310 is now 23.12 acres 	Implement Shoreline Management Policy
Parcel 313 (XNR-313PT)	Zone 7	68.01	<ul style="list-style-type: none"> 0.49 acre changed to Zone 6 (new Parcel 313a) Parcel 313 is now 67.52 acres and remains Zone 7 	Land Policy
Parcel 315 (XNR-315PT)	Zone 6	5.29	<ul style="list-style-type: none"> 0.50 acre changed to Zone 7 (new Parcel 315a) Parcel 315 is now 4.79 acres and remains Zone 6 	Implement Shoreline Management Policy
NA	Zone 1	NA	<ul style="list-style-type: none"> 3.1 acres changed to Zone 7 (new Parcel 310a) 0.13 acre changed to Zone 6 (new Parcel 310b) 	Administrative Error

¹ See [definitions of the land planning zones](#)

² More information is available in the fact sheets below. The fact sheets for the allocation changes are considered a supplement to the 2001 Norris RLMP.

Land Use Allocation Changes

After approval of a [reservoir land management plan](#) by TVA, all future uses of TVA-managed lands on that reservoir must then be consistent with the allocations within that RLMP.

³ In accordance TVA policies and guidelines, allocation changes after approval of an RLMP are only allowable under limited circumstances described below:

- (1) To correct administrative errors that occurred during the planning process
- (2) To implement TVA's [Shoreline Management Policy](#), consistent with the TVA [Land Policy](#)
- (3) To allow water-access for industrial or commercial recreation operations on private backlying property, consistent with the TVA [Land Policy](#)

Power properties are no longer included in RLMPs. Any previously planned power properties have been removed from interactive RLMP maps.

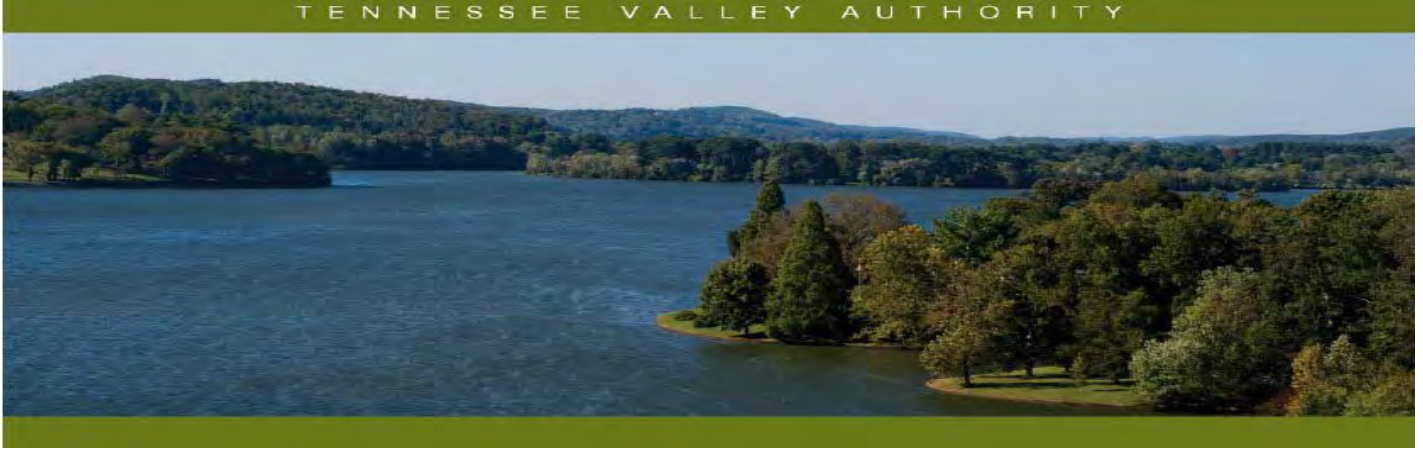

Norris Reservoir Land Management Plan Allocation Change – XNR-6PT and XNR-6aPT

Reservoir Land Planning Errors

After approval of a reservoir land management plan (RLMP) by the Tennessee Valley Authority (TVA), future uses of TVA-managed lands on that reservoir must then be consistent with the land use allocations within that RLMP. Certain TVA reservoir land tracts have land management zone allocations based on the backlying land use. These zone allocations have the potential to conflict with contractual agreements that may have been misinterpreted or overlooked. The resolution of these potential conflicts has resulted in the reallocation of the TVA-managed land to align with the contractual agreement present on the property. This document addresses the reallocation of a portion of Norris Plan Tract No. XNR-6PT (Parcel 6) to correct administrative errors and is considered a supplement to the 2001 Norris RLMP. Definitions of TVA's land planning allocation zones are available at www.tva.com/landplanzones.

General Information about Norris Reservoir

Norris Reservoir is an impoundment of the Clinch River formed by Norris Dam, which is located at Clinch River mile 79.8. Norris Reservoir is situated in Anderson, Campbell, Union, Claiborne, and Grainger counties in east Tennessee. TVA originally acquired 122,000 acres of land for construction of the reservoir, which was completed in 1936. TVA has retained 27,927 acres of reservoir shore land lying above full pool elevation. At full pool, the reservoir is 129 miles long; mainland shoreline length is 809 miles; and reservoir surface area is 34,200 acres.

Norris Parcel 6 (XNR-6PT) and Parcel 6a (XNR-6aPT)

XNR-6PT (903.74 acres) is located in Anderson County along the right descending bank of Clinch River mile 80.0 on Norris Reservoir. In the 2001 Norris RLMP, XNR-6PT was allocated as Zone 2 (Project Operations) for the Norris Dam Reservation. However, a 91.64-acre portion of this parcel should have been allocated as Zone 6 (Developed Recreation) to reflect a permanent easement granted to the State of Tennessee (XNR-125RE) for Norris Dam State Park. (The remaining 83.5 acres of TVA land included in the permanent easement for Norris Dam State Park is included as XNR-8PT (Parcel 8) and is allocated as "Developed Recreation.") The 91.64-acre portion of the 903.74-acre parcel has been modified as new Parcel 6a (XNR-6aPT) and the allocation has changed from "Project Operations" to "Developed Recreation." New Parcel 6a has approximately 6,700 linear feet of shoreline and the "Developed Recreation" allocation reflects the existing permanent easement for Norris Dam State Park. Further, a 7.38-acre area of inundated reservoir property was mistakenly included in the Parcel 6 acreage and has been removed. Parcel 6 acreage has changed from 903.74 acres to 804.72 acres and continues to be allocated as "Project Operations."

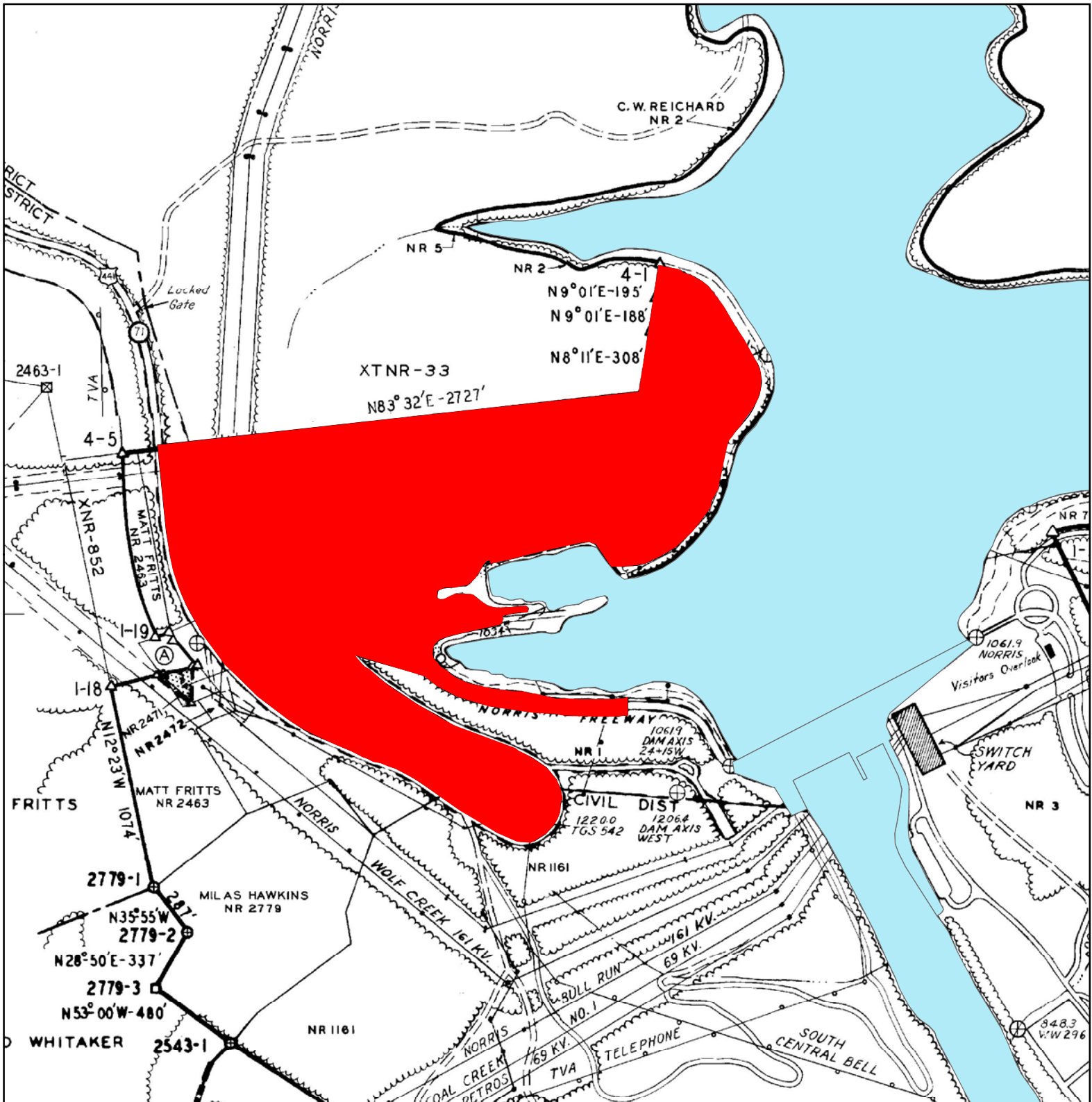



Exhibit Map

Land Use Allocation Change
 XNR-6PT and XNR-6aPT
 Anderson County, Tennessee
 Clinch River Mile 80.0R

 Area Reallocated to Zone 6
 (Approx. 91.64 acres)



Map Reference:
 D-Stage 1
 Quad - 137NE



Land and Water
 Stewardship

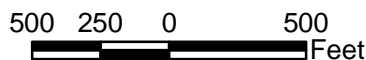

Norris Reservoir

December 17, 2013

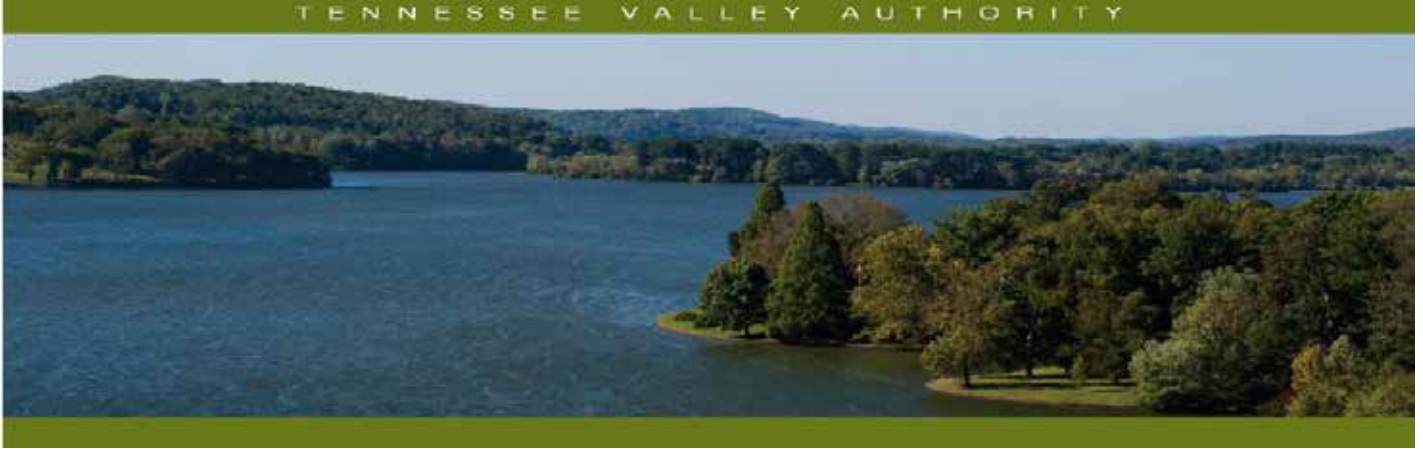

Norris Reservoir Land Management Plan Allocation Change – XNR-7PT

Reservoir Lands Planning Allocation Change

After approval of a reservoir land management plan (RLMP) by the Tennessee Valley Authority (TVA), future uses of TVA-managed lands on that reservoir must then be consistent with the land use allocations within that RLMP. Former TVA reservoir property reverts to Zone 1 (Non-TVA Shoreland). This document addresses the reallocation of a portion of Norris Plan Tract No. XNR-7PT no longer in TVA's ownership and is considered a supplement to the 2001 Norris RLMP. Definitions of TVA's land planning allocation zones are available at <https://www.tva.com/landplanzones>.

General Information about Norris Reservoir

Norris Reservoir is an impoundment of the Clinch River formed by Norris Dam, which is located at Clinch River mile 79.8. Norris Reservoir is situated in Anderson, Campbell, Union, Claiborne, and Grainger counties in east Tennessee. TVA originally acquired 122,000 acres of land for construction of the reservoir, which was completed in 1936. TVA has retained 27,927 acres of reservoir shore land lying above full pool elevation. At full pool, the reservoir is 129 miles long; mainland shoreline length is 809 miles; and reservoir surface area is 34,200 acres.

Norris Parcel 7 (XNR-7PT)

XNR-7PT (456.49 acres) is located in Anderson County, Tennessee along the left bank between Clinch River miles 78 and 81. In the 2001 Norris RLMP, XNR-7PT is allocated for Zone 4 (Natural Resource Conservation). However, TVA transferred approximately 423.89 acres of that land in 2006 to the State of Tennessee. TVA reallocated the transferred land to Zone 1 (Non-TVA Shoreland) to reflect the change in ownership. The remainder of XNR-7PT (32.6 acres) continues to be allocated as Zone 4 (Natural Resource Conservation).

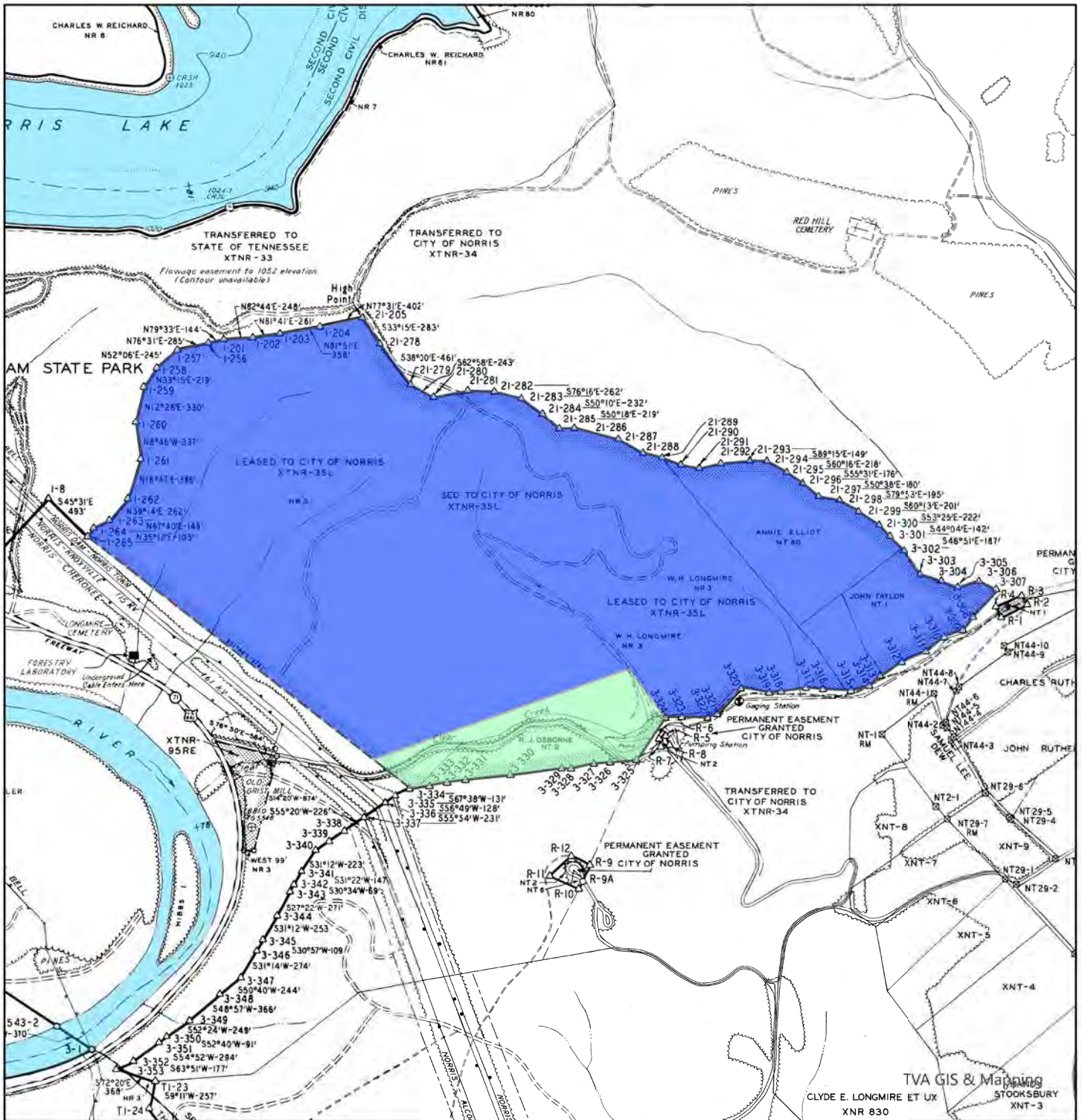

TVA GIS & Mapping
 CLYDE E. LONGMIRE ET UX
 XNR 830

Exhibit Map

Proposed Allocation Change

Anderson County, Tennessee

XNR-7PT

Clinch River Mile 78-81L

Map Reference:
 C/D Stage: 1, 3, 21
 Quad: 137NE



- Area to be Reallocated to Zone 1 (Approx. 423.89 acres)
- XNR-7PT- Area to Remain Zone 4 (Approx. 32.6 acres)



Norris Reservoir

December 14, 2023

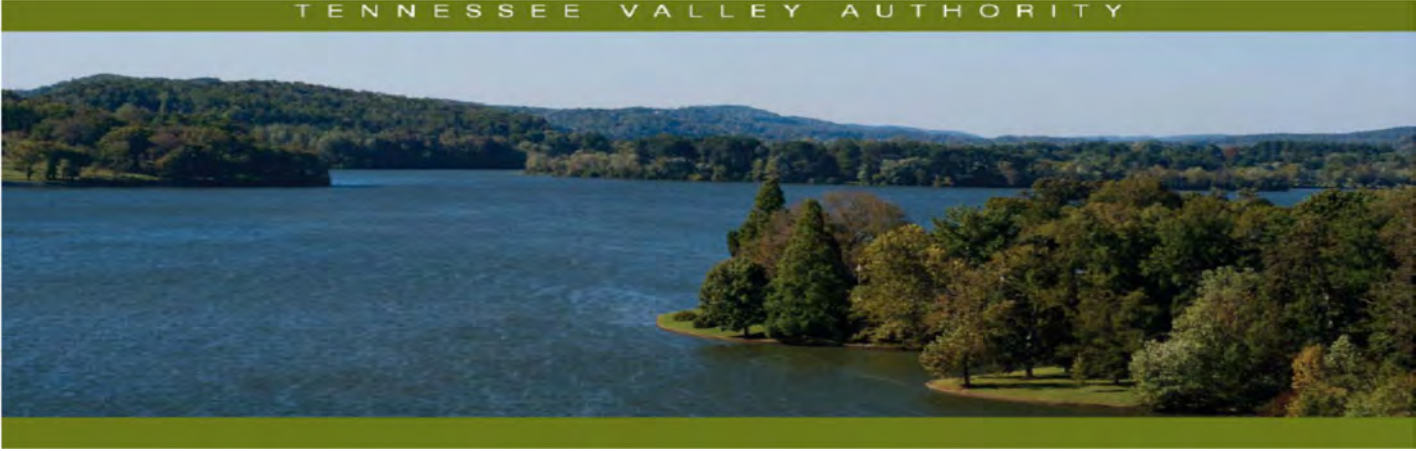

Norris Reservoir Land Management Plan Allocation Change – XNR-10PT

Reservoir Land Planning Errors

After approval of a reservoir land management plan (RLMP) by the Tennessee Valley Authority (TVA), future uses of TVA-managed lands on that reservoir must then be consistent with the land use allocations within that RLMP. However, legal or mapping errors found after the approval of a RLMP often need to be addressed when identified. This document addresses the reallocation of a portion of Norris Plan Tract No. XNR-10PT (XNR-10aPT) and is considered a supplement to the 2001 Norris RLMP. Definitions of TVA's land planning allocation zones are available at www.tva.com/landplanzones.

General Information about Norris Reservoir

Norris Reservoir is an impoundment of the Clinch River formed by Norris Dam, which is located at Clinch River mile 79.8. Norris Reservoir is situated in Anderson, Campbell, Union, Claiborne, and Grainger counties in east Tennessee. TVA originally acquired 122,000 acres of land for construction of the reservoir, which was completed in 1936. TVA has retained 27,927 acres of reservoir shore land lying above full pool elevation. At full pool, the reservoir is 129 miles long; mainland shoreline length is 809 miles; and reservoir surface area is 34,200 acres.

Norris Parcel 10PT (XNR-10PT)

XNR-10PT (73.81 acres) is located in Campbell County along the right descending bank of Cove Creek mile 5.2 on Norris Reservoir. In the 2001 Norris RLMP, XNR-10PT was allocated as Sensitive Resource Management (Zone 3) for cultural resources, sensitive plant species and the Oak Grove River Bluffs TVA Habitat Protection Area. However, a portion of XNR-10PT occupies the area of a public launching ramp access area that was in existence prior to the approval of the 2001 Norris RLMP. In order to resolve the potential land use conflict with the "Sensitive Resource Management" allocation, a 1.43-acre portion of the parcel has been reallocated to Developed Recreation (Zone 6) and renamed XNR-10aPT. Requests for public recreation agreements and associated water-use facilities would be considered on XNR-10aPT. The remainder of XNR-10PT (72.38 acres) remains allocated as "Sensitive Resource Management."

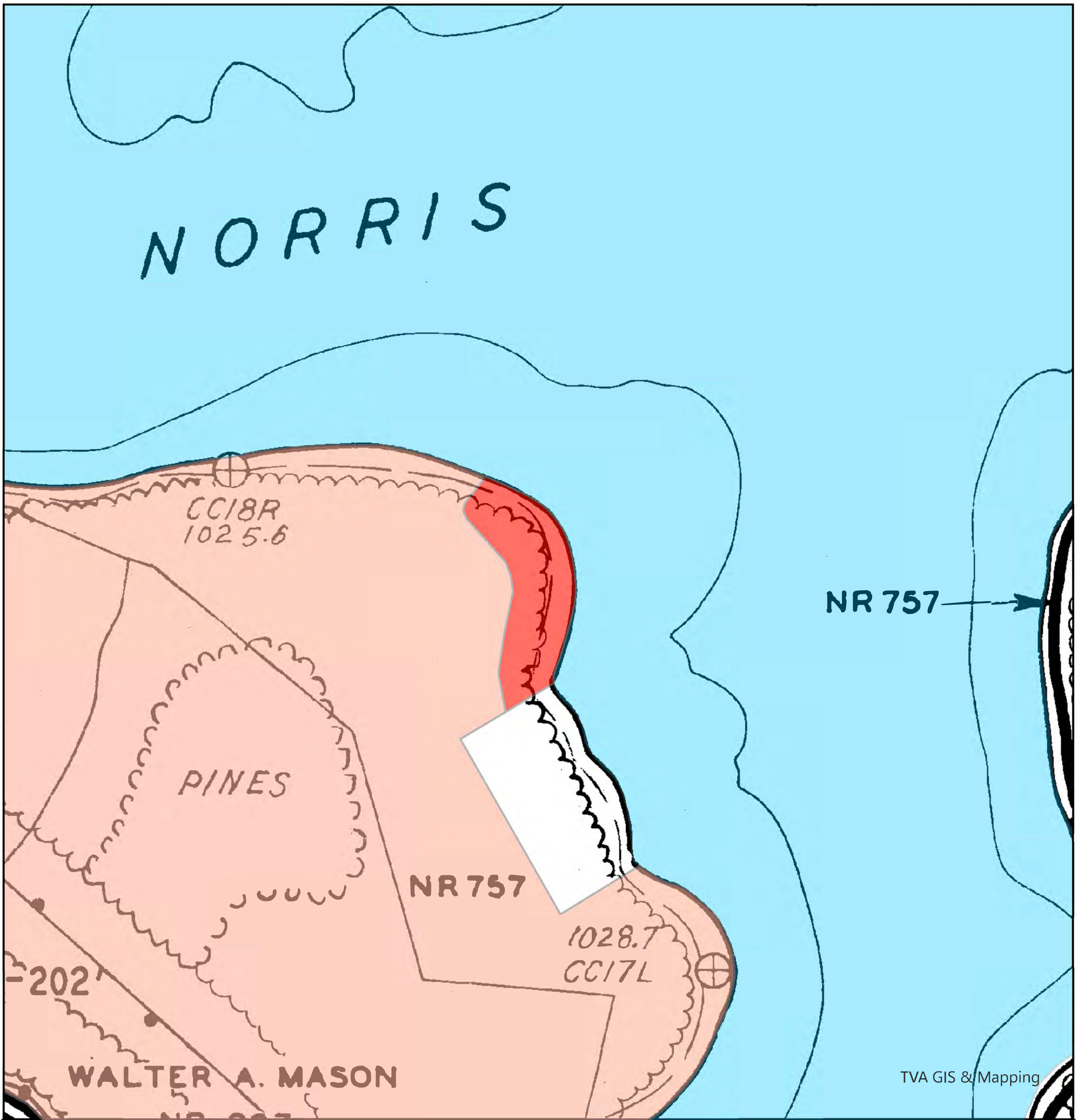



Exhibit Map

Proposed Allocation Change
Campbell County, Tennessee

XNR-10PT
Cove Creek 5.2R

Map Reference:
C/D Stage: 5
Quad: 136SW

-  XNR-10aPT -Area to be Reallocated to Zone 6 (Approx. 1.43 acres)
-  XNR-10PT-Area to Remain Zone 3 (Approx. 72.38 acres)



Norris Reservoir

April 7, 2025

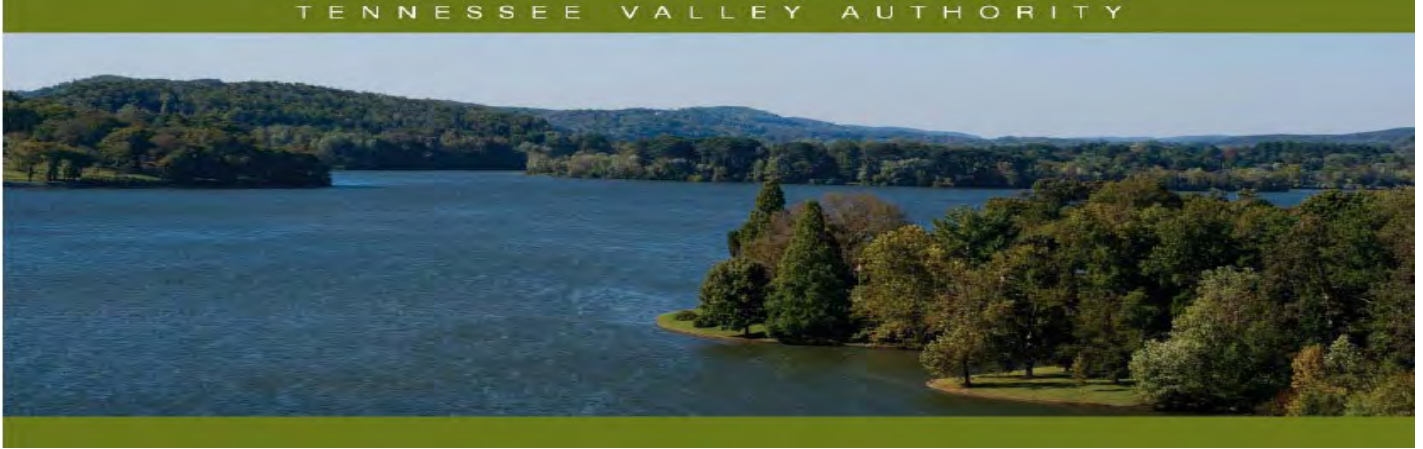

Norris Reservoir Land Management Plan Allocation Change – XNR-21PT (XNR-21aPT)

Reservoir Land Planning Allocation Changes

After approval of a reservoir land management plan (RLMP) by the Tennessee Valley Authority (TVA), future uses of TVA-managed lands on that reservoir must then be consistent with the land use allocations within that RLMP. Certain TVA reservoir land tracts have land management zone allocations based on the backlying land use. These zone allocations have the potential to conflict with egress and ingress rights of the adjacent property owners if the backlying land use were to change. The resolution of these potential conflicts has resulted in the reallocation of the TVA-managed land to align with the egress and ingress rights of the adjacent property owners. This document addresses the reallocation of a portion of Norris Plan Tract No. XNR-21PT (XNR-21aPT) and is considered a supplement to the 2001 Norris RLMP. Definitions of TVA's land planning allocation zones are available at <https://www.tva.com/landplanzones>.

General Information about Norris Reservoir

Norris Reservoir is an impoundment of the Clinch River formed by Norris Dam, which is located at Clinch River mile 79.8. Norris Reservoir is situated in Anderson, Campbell, Union, Claiborne, and Grainger counties in east Tennessee. TVA originally acquired 122,000 acres of land for construction of the reservoir, which was completed in 1936. TVA has retained 27,927 acres of reservoir shore land lying above full pool elevation. At full pool, the reservoir is 129 miles long; mainland shoreline length is 809 miles; and reservoir surface area is 34,200 acres.

Norris Parcel 21 (XNR-21PT), Parcel 21a (XNR-21aPT)

XNR-21PT (3.11 acres) is located in Campbell County, Tennessee along the right bank at Cove Creek mile 12.1. In the 2001 Norris RLMP, XNR-21PT is allocated for Zone 6 (Developed Recreation). A portion of XNR-21PT is currently under license for commercial recreation. XNR-21PT fronts a tract of former TVA land, XNR-637, which TVA sold subject to Section 31 of the TVA Act of 1933. In the deed, TVA granted the owners the right of ingress and egress to and from the waters of Norris Lake for the purposes of constructing and maintaining water use facilities. A 0.12-acre portion of this land is not associated with the commercial recreation area, and there is a pending request for a private water-use facility. In order to resolve the potential conflicts from the 2001 RLMP allocations which do not allow for private water use facilities, a 0.12-acre portion of XNR-21PT was reallocated to "Residential Access" and designated as Parcel 21a (XNR-21aPT). XNR-21PT now consists of 2.99 acres and remains allocated as "Developed Recreation."

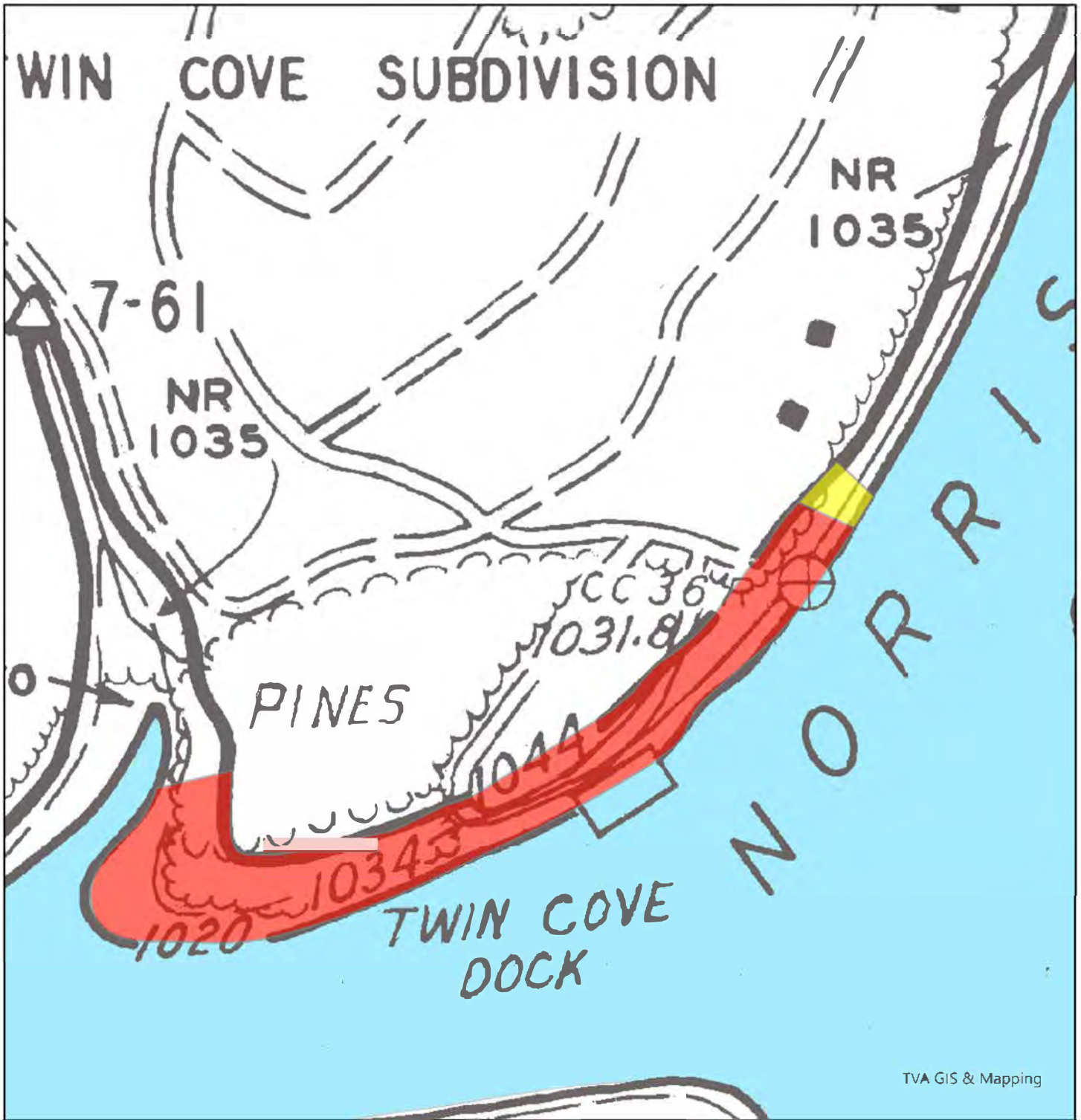

TVA GIS & Mapping

XNR-21aPT-Area to be Reallocated to Zone 7 (Approx. 0.12 acre)

XNR-21PT-Area to Remain Zone 6 (Approx. 2.99 acres)

Exhibit Map

Proposed Allocation Change

Campbell County, Tennessee

XNR-21PT

Cove Creek mile 12.1R

Map Reference:
C/D Stage: 7, 8
Quad: 136SW

Norris Reservoir

200 0 200

Feet

N

Natural Resources

September 10, 2024

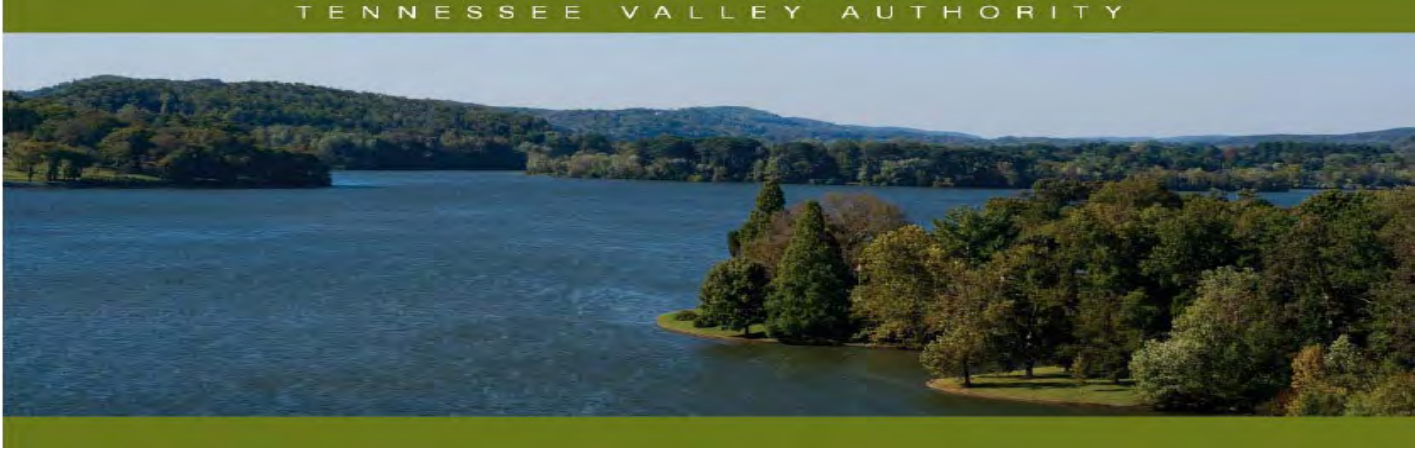

Norris Reservoir Land Management Plan Allocation Change – XNR-66PT

Reservoir Land Planning Errors

After approval of a reservoir land management plan (RLMP) by the Tennessee Valley Authority (TVA), future uses of TVA-managed lands on that reservoir must then be consistent with the land use allocations within that RLMP. Certain TVA reservoir land tracts have land management zone based on the backlying land use. These zone allocations have the potential to conflict with ingress and egress rights of the adjacent property owners if the backlying land use were to change. The resolution of these potential conflicts has resulted in the reallocation of the TVA-managed land to align with the ingress and egress rights of the adjacent property owners. This document addresses the reallocation of a portion of Norris Plan Tract No. XNR-66PT (XNR-66aPT) and is considered a supplement to the 2001 Norris RLMP. Definitions of TVA's land planning allocation zones are available at www.tva.com/landplanzones.

General Information about Norris Reservoir

Norris Reservoir is an impoundment of the Clinch River formed by Norris Dam, which is located at Clinch River mile 79.8. Norris Reservoir is situated in Anderson, Campbell, Union, Claiborne, and Grainger counties in east Tennessee. TVA originally acquired 122,000 acres of land for construction of the reservoir, which was completed in 1936. TVA has retained 27,927 acres of reservoir shore land lying above full pool elevation. At full pool, the reservoir is 129 miles long; mainland shoreline length is 809 miles; and reservoir surface area is 34,200 acres.

Norris Parcel 66PT (XNR-66PT)

XNR-66PT (6.97 acres) is located in Campbell County along the left descending bank of Big Creek mile 8.5 on Norris Reservoir. In the 2001 Norris RLMP, XNR-66PT was allocated as Developed Recreation (Zone 6) for an existing commercial marina. However, a portion of XNR-66PT fronts a residential area, part of former TVA tract XNR-655, which TVA sold subject to Section 31 of the TVA Act of 1933. In the deed, TVA granted the owners the right of ingress and egress rights to and from the waters of Norris Lake over and upon the adjoining land lying between the 1044-foot contour elevation and the waters of the lake, and the deed does not contain any restrictions otherwise limiting those rights. In order to resolve the potential land use conflict with the "Developed Recreation" allocation, a 1.17-acre portion of the 6.97-acre parcel has been reallocated to "Shoreline Access" (Zone 7) and renamed XNR-66aPT. Requests for private water use facilities would be considered on XNR-66aPT. The remainder of XNR-66PT (5.8 acres) remains allocated as "Developed Recreation."

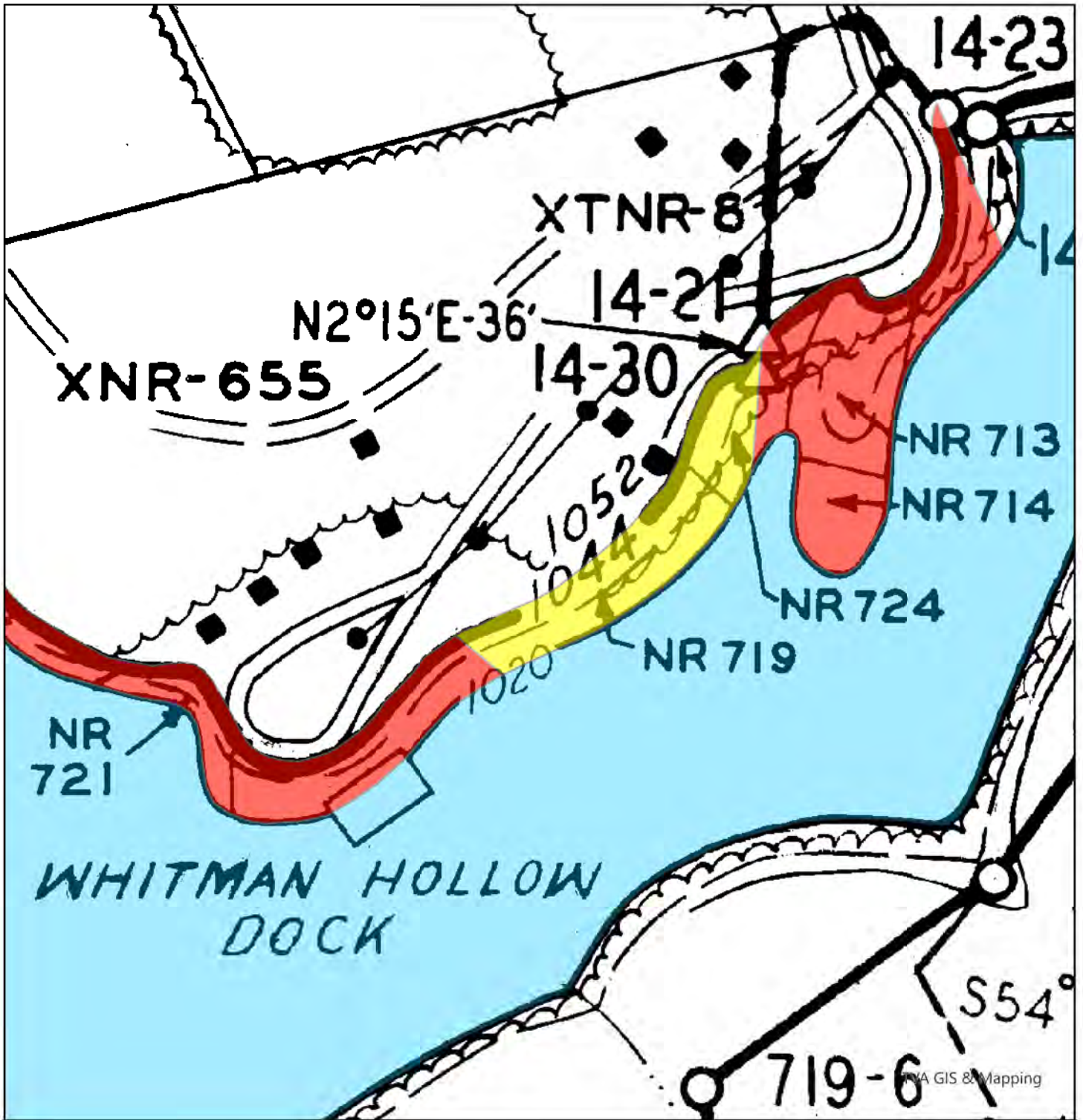
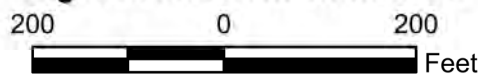

Exhibit Map

Proposed Allocation Change
Campbell County, Tennessee

XNR-66PT

Big Creek River Mile 8.5L



Map Reference:
C/D Stage: 14
Quad: 136SE



- XNR-66aPT - Area to be Reallocated to Zone 7 (Approx. 1.17 acre)
- XNR-66PT - Area to Remain Zone 6 (Approx. 5.8 acres)

Norris Reservoir

December 8, 2023



Norris Reservoir Land Management Plan Allocation Change – XNR-80PT and XNR-80aPT

Reservoir Land Planning Errors

After approval of a reservoir land management plan (RLMP) by the Tennessee Valley Authority (TVA), all future uses of TVA-managed lands on that reservoir must then be consistent with the allocations within that RLMP. Certain TVA reservoir land tracts have land management zone allocations based on the backlying land use. These zone allocations have the potential to conflict with egress and ingress rights of the adjacent property owners if the back-lying land use were to change. The resolution of these potential conflicts has resulted in the reallocation of the TVA-managed land to align with the egress and ingress rights of the adjacent property owners. This document addresses the reallocation of a portion of Norris RLMP Plan Tract No. XNR-80PT (Parcel 80) and is considered a supplement to the 2001 Norris RLMP. Definitions of TVA's land use zone allocations are available at www.tva.com/landplanzones.

General Information about Norris Reservoir

Norris Reservoir is an impoundment of the Clinch River formed by Norris Dam, which is located at Clinch River mile (CRM) 79.8. Norris Reservoir is located in the Tennessee counties of Anderson, Campbell, Claiborne, Grainger, and Union. TVA originally acquired 122,000 acres of land for construction of the reservoir, which was completed in 1936. TVA has retained 27,927 acres of land lying above full pool elevation. At full pool, the reservoir is 129 miles long; mainland shoreline length is 809 miles; and surface area is 34,200 acres.

Norris Parcel 80 (XNR-80PT) and Parcel 80a (XNR-80aPT)

XNR-80PT (8.23 acres) is located in Campbell County, Tennessee, along the right descending bank of CRM 88.2. In the 2001 RLMP, XNR-80PT is allocated as Zone 6 (Developed Recreation). However, a portion of XNR-80PT fronts a parcel of former TVA land, XNR-863, which TVA sold subject to Sections 4(k)(a) and 31 of the TVA Act. Upon the sale of these lands, TVA granted the "right of ingress and egress over the adjoining land lying between the 1044-foot contour elevation and the waters of the lake." This former TVA land is now used for residential purposes. In accordance with TVA's Shoreline Management Policy, former TVA land encumbered with certain deeded access rights may be used for residential shoreline access. The access rights in the deed combined with the residential land use warrants an allocation change to reflect shoreline access rights. In order to resolve the potential conflict of the allocation for "Developed Recreation," XNR-80PT is modified to consist of new XNR-80aPT (2.85 acres) and XNR-80PT acreage changed to 5.37 acres and remains allocated as "Developed Recreation" (see Exhibit Map). XNR-80aPT (Parcel 80a) fronts Rainbow Richland Subdivision and occupies approximately 1,575 feet of shoreline. XNR-80aPT is now allocated as Zone 7 (Shoreline Access) and requests for private water use facilities will be considered for this parcel.

Figure 1. XNR-80PT Exhibit Map

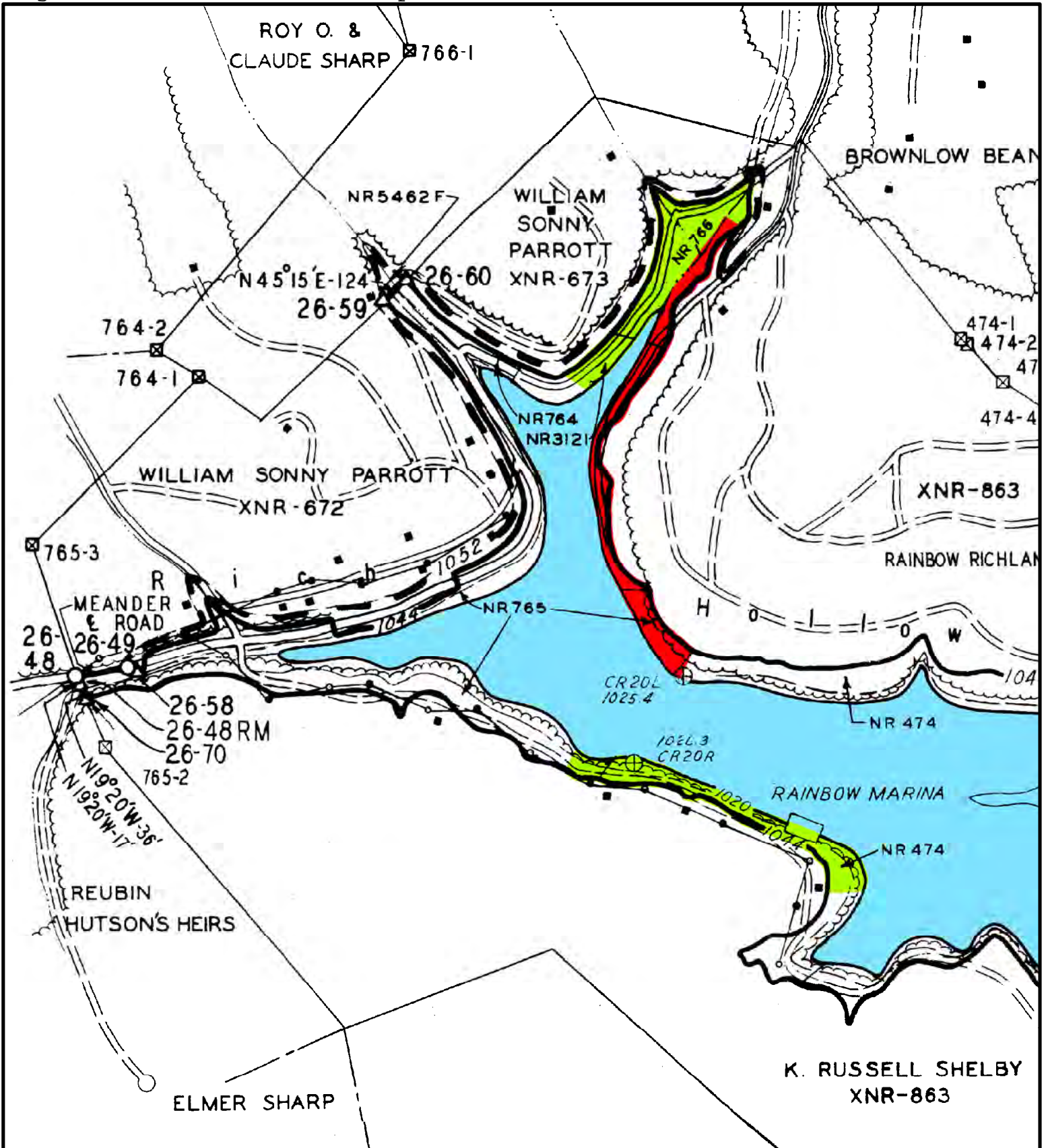

- Area Reallocated to Zone 7
- XNR-80aPT
(Approx. 2.8 acres)
- Area To Remain Zone 6
- XNR-80PT
(Approx. 5.4 acres)

Exhibit Map
Land Use Allocation Change
XNR-80PT and XNR-80aPT
Campbell County, Tennessee
Clinch River Mile 88.2



Map Reference:
C/D Stage: 26
Quad: 136SE



Property and Natural
Resources

December 17, 2012

Norris Reservoir

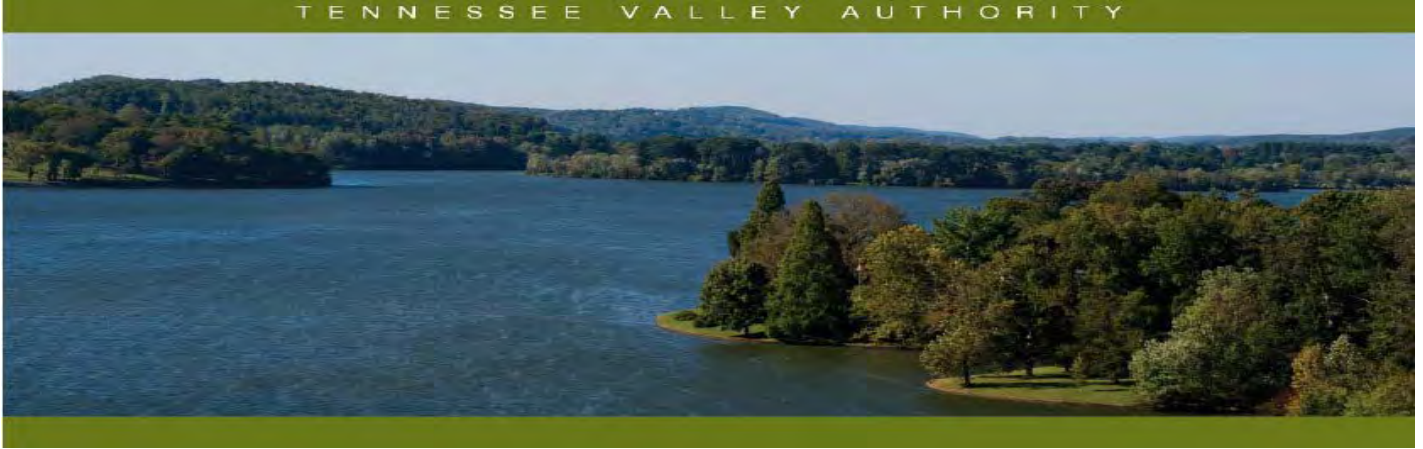

Norris Reservoir Land Management Plan Allocation Change – XNR-80PT and XNR-80bPT

Reservoir Lands Planning Allocation Change

After approval of a reservoir land management plan (RLMP) by the Tennessee Valley Authority (TVA), future uses of TVA-managed lands on that reservoir must then be consistent with the land use allocations within that RLMP. TVA has determined that a portion of Parcel 80 (Plan Tract No. XNR-80PT) qualifies for an allocation change due to a change in the backlying land use and existing ingress and egress rights. Certain TVA reservoir parcels are allocated to land use zones based on the backlying land use, and in the case of Parcel 80, it was allocated as Zone 6 (Developed Recreation) in the 2001 Norris RLMP for an existing commercial marina. In some areas, the backlying land use has changed to residential and the “Developed Recreation” allocation conflicts with some areas with ingress and egress rights of the adjacent property owners. This document addresses the reallocation of a 1.0-acre portion of XNR-80PT to Zone 7 (Shoreline Access) and is considered a supplement to the 2001 Norris RLMP. Definitions of TVA’s land planning allocation zones are available at <https://www.tva.com/landplanzones>.

General Information about Norris Reservoir

Norris Reservoir is an impoundment of the Clinch River formed by Norris Dam, which is located at Clinch River mile 79.8. Norris Reservoir is situated in Anderson, Campbell, Union, Claiborne, and Grainger counties in east Tennessee. TVA originally acquired 122,000 acres of land for construction of the reservoir, which was completed in 1936. TVA has retained 27,927 acres of reservoir shore land. At full pool, the reservoir is 129 miles long; mainland shoreline length is 809 miles; and reservoir surface area is 34,200 acres.

Norris Parcel 80 (XNR-80PT) and new Parcel 80b (XNR-80bPT)

XNR-80PT (8.2 acres) is located in Campbell County along the left descending bank of Clinch River mile 88.2 on Norris Reservoir. In the 2001 Norris RLMP, Parcel 80 was allocated as “Developed Recreation” and is described as predominately wooded. Since 2001, XNR-80PT acreage has changed from 8.2 acres to 5.4 acres due to an allocation change to “Shoreline Access” on a 2.8-acre portion (Parcel 80a) in 2012. A 1.0-acre portion that fronts a tract of former TVA property, XNR-863, which TVA sold subject to Section 31 of the TVA Act of 1933 qualifies for an allocation change to “Shoreline Access.” In the deed, TVA granted the owners the right of ingress and egress rights to and from the waters of Norris Lake over and upon the adjoining land lying between the 1044-foot contour elevation and the waters of the lake, and the deed does not contain any restrictions otherwise limiting those rights. A 1.0-acre portion of Parcel 80 has been re-designated as new Parcel 80b (XNR-80bPT) and the land use allocation changes to “Shoreline Access.” Parcel 80b has approximately 480 linear feet of shoreline and the “Shoreline Access” allocation reflects the deeded access rights of ingress and egress across TVA shoreline property of the backlying property owners. Requests for private water use facilities would be considered on XNR-80bPT. The remaining 4.4 acres of XNR-80PT remains allocated as “Developed Recreation.”

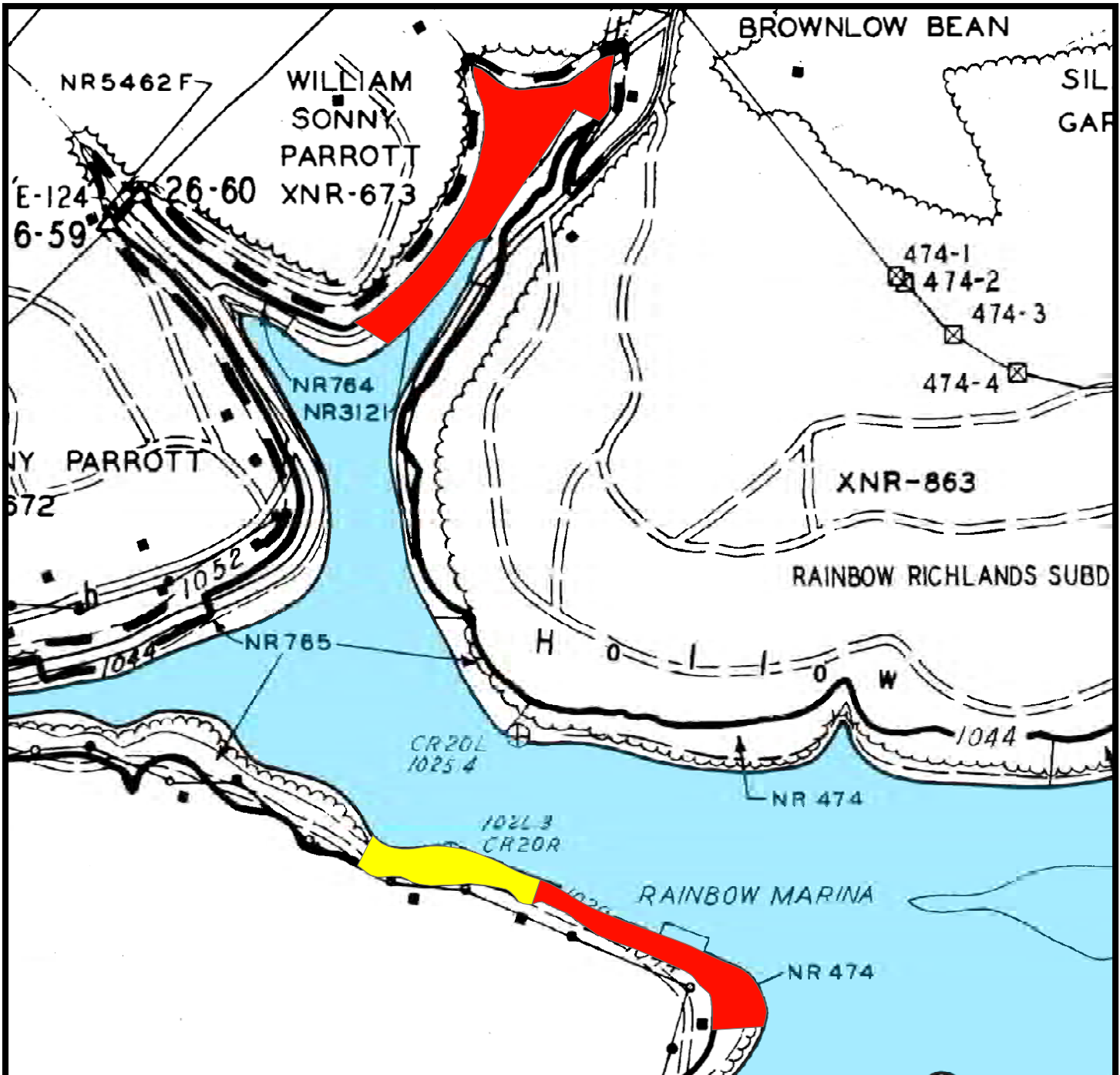

Exhibit Map

- XNR-80bPT - Area to be Reallocated to Zone 7 (Approx. 1.03 acres)
- XNR-80PT - Area to Remain as Zone 6 (Approx. 4.34 acres)

Proposed Allocation Change
 Campbell County, Tennessee
 XNR-80PT and XNR-80bPT
 Clinch River Mile 88.1 R

Map Reference: C/D
 Stage: 26D
 Quad: 136SE



Natural Resources

Norris Reservoir

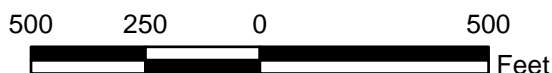

December 13, 2018

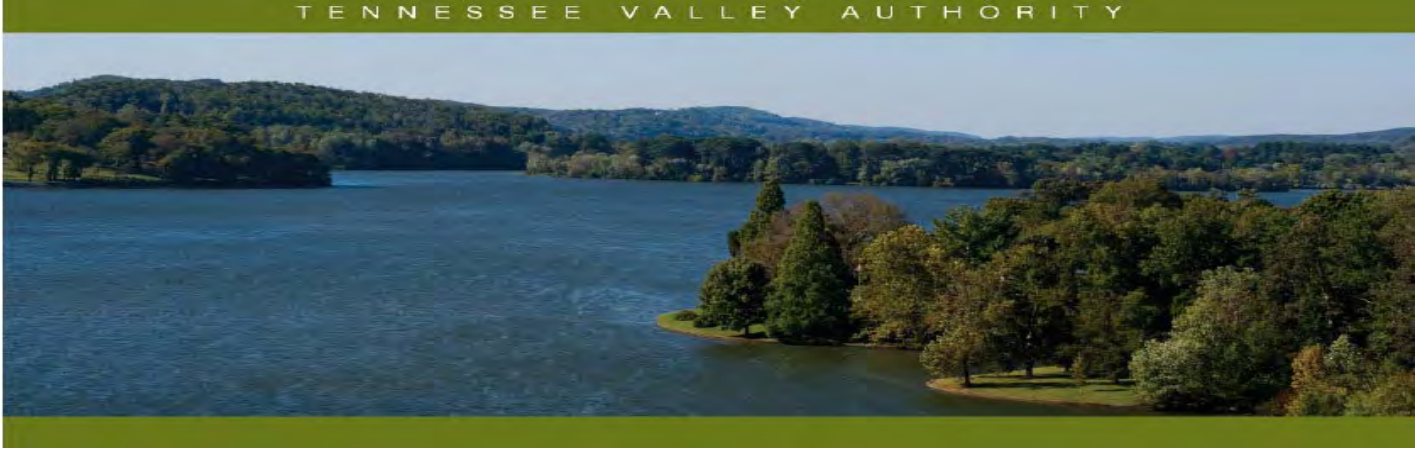

Norris Reservoir Land Management Plan Error – XNR-108PT and XNR-108aPT

Reservoir Land Planning Errors

After approval of a reservoir land management plan (RLMP) by the Tennessee Valley Authority (TVA), future uses of TVA-managed lands on that reservoir must then be consistent with the land use allocations within that RLMP. Certain TVA reservoir land tracts have land management zone based on the backlying land use. These zone allocations have the potential to conflict with ingress and egress rights of the adjacent property owners if the backlying land use were to change. The resolution of these potential conflicts has resulted in the reallocation of the TVA-managed land to align with the ingress and egress rights of the adjacent property owners. This document addresses the reallocation of a portion of Norris Plan Tract No. XNR-108PT (XNR-108aPT) and is considered a supplement to the 2001 Norris RLMP. Definitions of TVA's land planning allocation zones are available at <https://www.tva.com/landplanzones>.

General Information about Norris Reservoir

Norris Reservoir is an impoundment of the Clinch River formed by Norris Dam, which is located at Clinch River mile 79.8. Norris Reservoir is situated in Anderson, Campbell, Union, Claiborne, and Grainger counties in east Tennessee. TVA originally acquired 122,000 acres of land for construction of the reservoir, which was completed in 1936. TVA has retained 27,927 acres of reservoir shore land lying above full pool elevation. At full pool, the reservoir is 129 miles long; mainland shoreline length is 809 miles; and reservoir surface area is 34,200 acres.

Norris Parcel 108 (XNR-108PT) and Parcel 108a (XNR-108aPT)

XNR-108PT (8.75 acres) is located in Campbell County, Tennessee along the right bank at Davis Creek mile 4.0R. In the 2001 Norris RLMP, XNR-108PT is allocated for Zone 7 (Shoreline Access). However, a portion of XNR-108PT fronts a TVA sale tract with retained rights that restricts the property solely for commercial recreational use. In order to resolve the potential conflicts from the 2001 RLMP allocation, the 0.45 acre portion was changed to "Developed Recreation" in order to recognize the backlying deed restriction. The remainder of XNR-108PT (8.3 acres) continues to be allocated as "Shoreline Access."

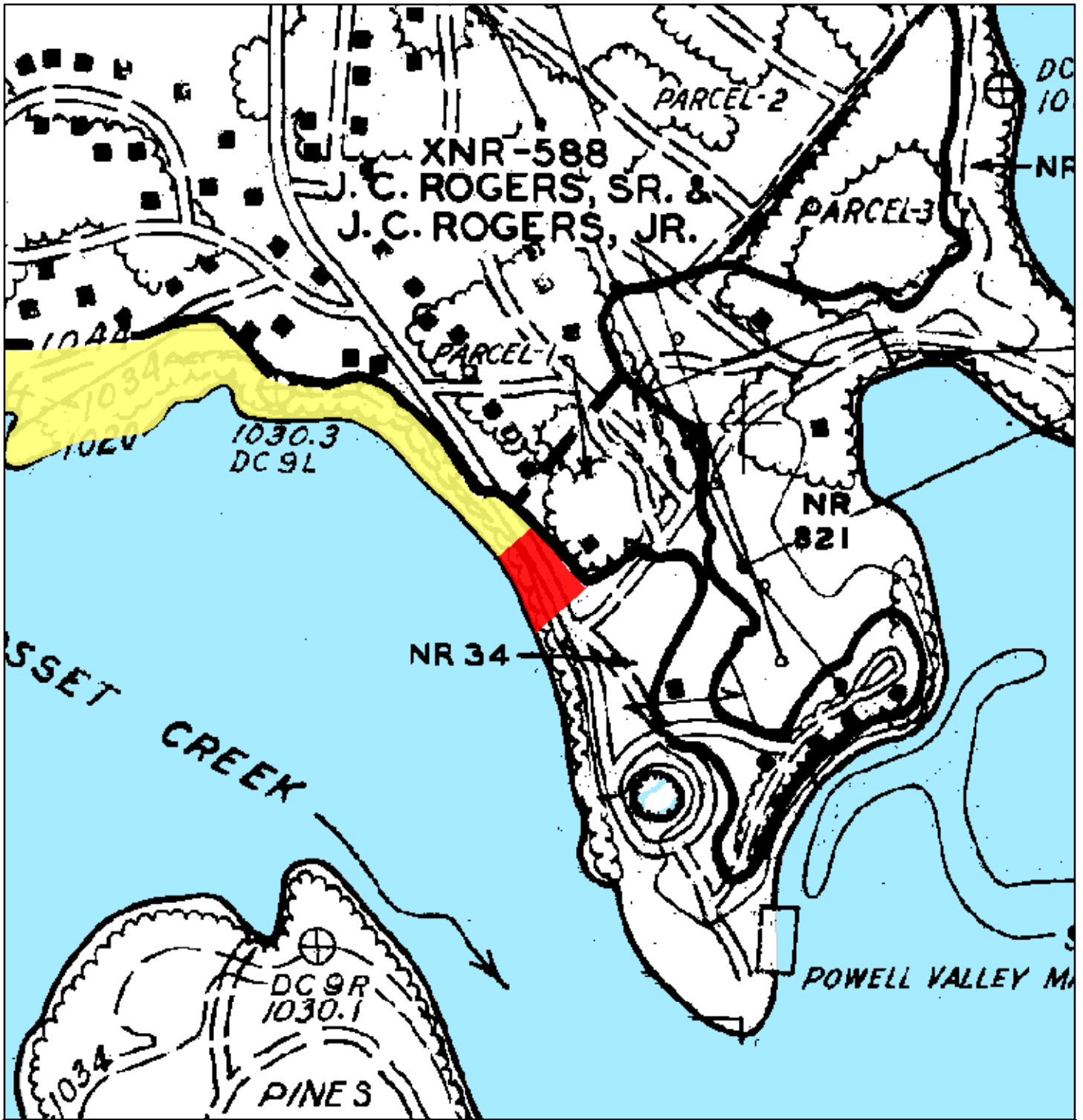

XNR-108aPT - Area to Reallocate to Zone 6 (Approx. 0.45 acre)



XNR-108PT - Area to Remain Allocated as Zone 7 (Approx. 8.3 acres)

Attachment 1 - Exhibit
 Proposed Allocation Change
 Campbell County, Tennessee
 XNR-108PT
 Davis Creek Mile 4R

Map Reference:
 Dstage: 36 & 37
 Quad: 145NW



Norris Reservoir

April 5, 2021

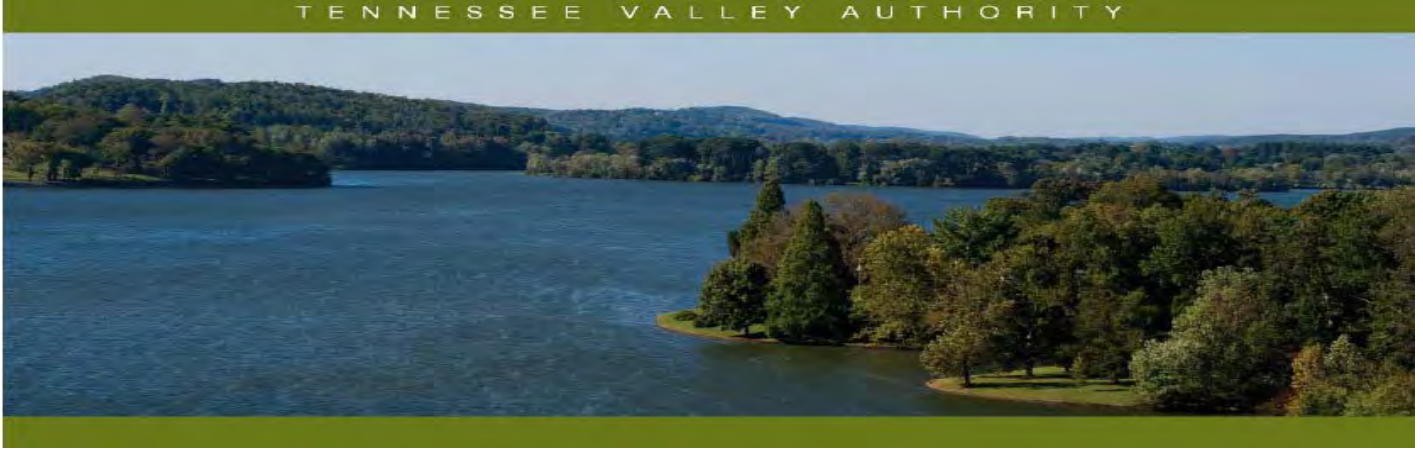

Norris Reservoir Land Management Plan Allocation Change – XNR-121PT and XNR-121aPT

Reservoir Land Planning Errors

After approval of a reservoir land management plan (RLMP) by the Tennessee Valley Authority (TVA), future uses of TVA-managed lands on that reservoir must then be consistent with the land use allocations within that RLMP. Recent research of deeds shows that on certain TVA reservoir land tracts and the current land use allocations have the potential to conflict with ingress and egress rights of the adjacent property owners if the backlying land use were to change. The resolution of these potential conflicts involves the reallocation of certain TVA-managed land to align with deeded ingress and egress rights across TVA shoreline property of the backlying property owners. This document addresses the reallocation of a portion of Norris Plan Tract No. XNR-121PT (XNR-121aPT) and is considered a supplement to the 2001 Norris RLMP. Definitions of TVA's land planning allocation zones are available at www.tva.gov/landplanzones.

General Information about Norris Reservoir

Norris Reservoir is an impoundment of the Clinch River formed by Norris Dam, which is located at Clinch River mile 79.8. Norris Reservoir is situated in Anderson, Campbell, Union, Claiborne, and Grainger counties in east Tennessee. TVA originally acquired 122,000 acres of land for construction of the reservoir, which was completed in 1936. TVA has retained 27,927 acres of reservoir shore land lying above full pool elevation. At full pool, the reservoir is 129 miles long; mainland shoreline length is 809 miles; and reservoir surface area is 34,200 acres.

Norris Parcel 121 (XNR-121PT) and Parcel 121a (XNR-121aPT)

XNR-121PT (2,147.03 acres) is located in Union County along the left descending bank of Leadmine Bend Creek mile 0.5 of the Powell River arm of Norris Reservoir. In the 2001 Norris RLMP, XNR-121PT was allocated as Zone 4 (Natural Resource Conservation). However, XNR-121PT fronts a tract of land, XNR-702, which TVA sold subject to Section 31 of the TVA Act of 1933. Upon the sale of this land, TVA granted the "right of ingress to and egress from the waters of Norris Lake over and upon the adjoining land lying between the 1044-foot contour elevation and the waters of the lake." In order to resolve the potential land use conflict with the allocation to "Natural Resources Conservation," which does not allow for private water use facilities, a 7.23-acre portion of the 2,147.03-acre parcel has been modified as XNR-121aPT (Figure 1) and the land use allocation has changed from "Natural Resources Conservation" to Zone 7 (Shoreline Access). XNR-121aPT has approximately 1,396 linear feet of shoreline and allocation to "Shoreline Access" reflects the deeded access rights of ingress and egress across TVA shoreline property of the backlying property owner. Requests for private water use facilities would be considered on XNR-121aPT. XNR-121PT consists of the remainder of the original reservoir land tract (XNR-121PT) and remains allocated as "Natural Resource Conservation."

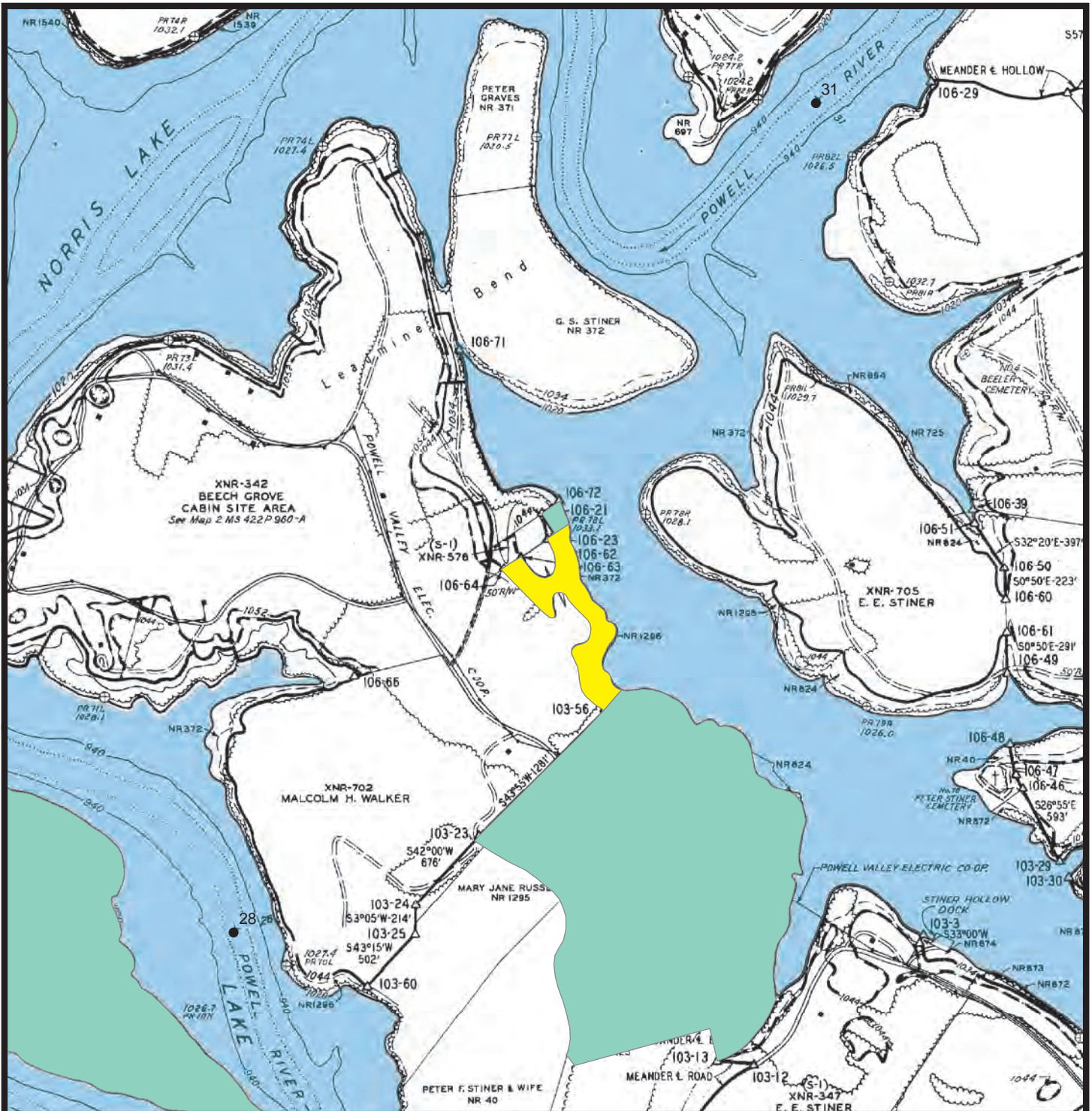

Exhibit Map

- XNR-121aPT - Area Reallocated to Zone 7 (Approx. 7.2 acres)
- XNR-121PT - Area to Remain Zone 4 (Approx. 2,139.8 acres)

Land Use Allocation Change XNR-121PT and XNR-121aPT Union County, Tennessee Leadmine Bend Creek Mile 0.5L

Map Reference:
D-Stage: 103 & 106
Quad: 145NE



Natural Resources



Norris Reservoir

April 17, 2018

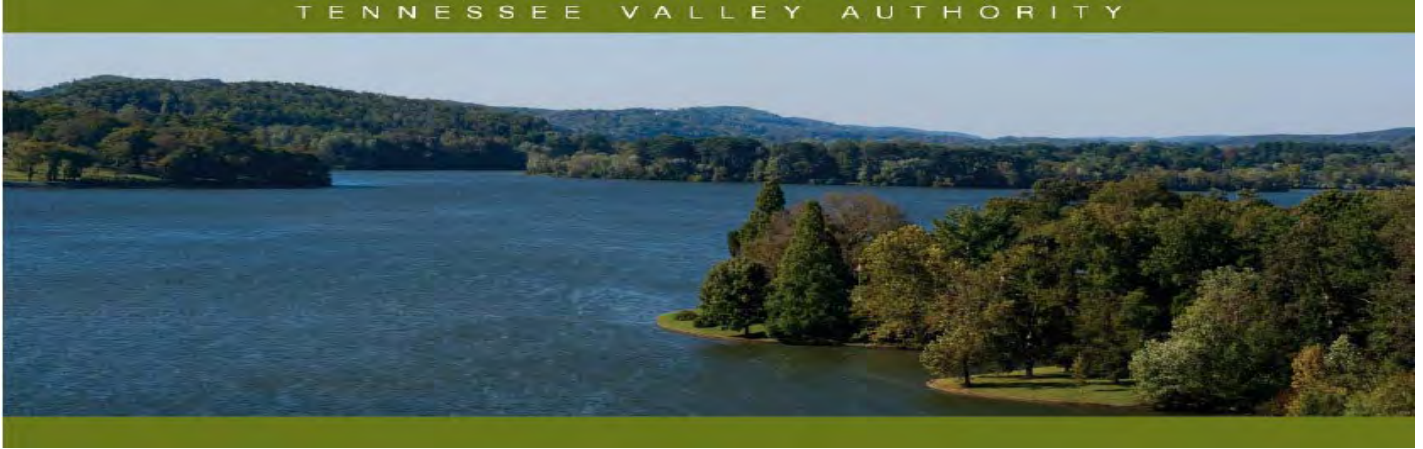

Norris Reservoir Land Management Plan Error – XNR-159PT (XNR-159aPT) and XNR-160PT

Reservoir Land Planning Errors

After approval of a reservoir land management plan (RLMP) by the Tennessee Valley Authority (TVA), future uses of TVA-managed lands on that reservoir must then be consistent with the land use allocations within that RLMP. Certain TVA reservoir land tracts have land management zones based on the backlying land use. These zone allocations have the potential to conflict with ingress and egress rights of the adjacent property owners if the backlying land use were to change. The resolution of these potential conflicts has resulted in the reallocation of the TVA-managed land to align with the ingress and egress rights of the adjacent property owners. This document addresses the reallocation of a portion of Norris Plan Tract No. XNR-159PT (XNR-159aPT) and XNR-160PT and is considered a supplement to the 2001 Norris RLMP. Definitions of TVA's land planning allocation zones are available at <https://www.tva.com/landplanzones>.

General Information about Norris Reservoir

Norris Reservoir is an impoundment of the Clinch River formed by Norris Dam, which is located at Clinch River mile 79.8. Norris Reservoir is situated in Anderson, Campbell, Union, Claiborne, and Grainger counties in east Tennessee. TVA originally acquired 122,000 acres of land for construction of the reservoir, which was completed in 1936. TVA has retained 27,927 acres of reservoir shore land lying above full pool elevation. At full pool, the reservoir is 129 miles long; mainland shoreline length is 809 miles; and reservoir surface area is 34,200 acres.

Norris Parcel 159 (XNR-159PT), Parcel 159a (XNR-159aPT) and Parcel 160 (XNR-160PT)

XNR-159PT (25.39 acres) and XNR-160PT (5.64 acres) are both located in Union County, Tennessee along the left bank at Powell River mile 30.7. In the 2001 Norris RLMP, XNR-159PT is allocated for Zone 6 (Developed Recreation) and XNR-160PT is allocated for Zone 4 (Natural Resource Conservation). However, a portion of XNR-159PT and all of XNR-160PT fronts a tract of former TVA land, XNR-350, which TVA sold subject to Section 31 of the TVA Act of 1933. In the deed, TVA granted the owners the right of ingress to and egress from the waters of Norris Lake for the purposes of constructing and maintaining water use facilities. In order to resolve the potential conflicts from the 2001 RLMP allocations which do not allow for private water use facilities, a 0.16-acre portion of XNR-159PT and the entire 5.64 acres of XNR-160PT were changed to "Residential Access". The 0.16-acre portion of XNR-159PT has been designated as Parcel 159a (XNR-159aPT) and the remainder of XNR-159PT designation will remain the same. XNR-159PT now consists of 25.23 acres and remains allocated as "Developed Recreation."

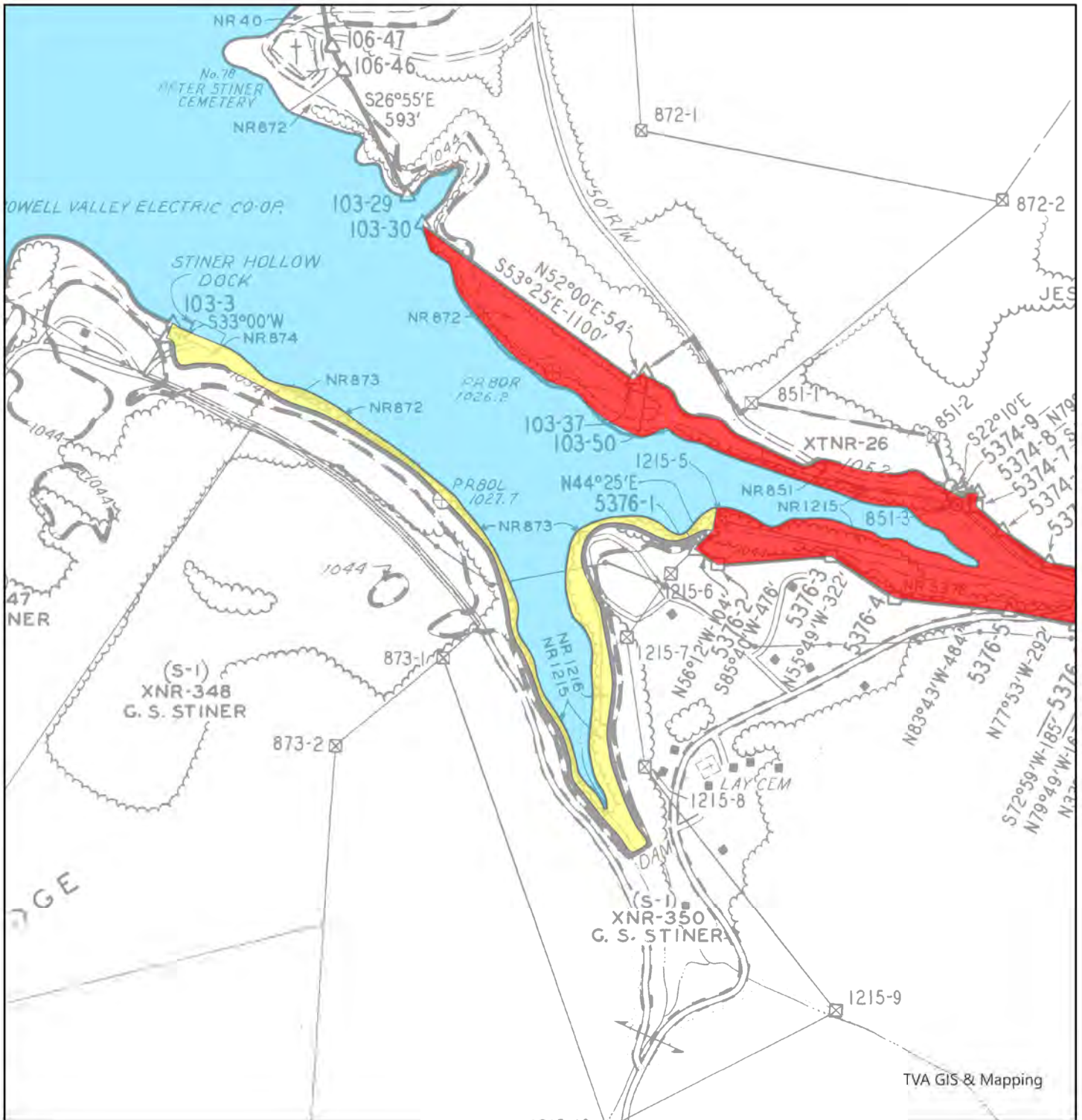

- Tract no. XNR-159aPT and XNR-160PT - Area To Reallocate To Zone 7 (Approx. 5.8 acres)
- Tract no. XNR-159PT - Area To Remain Allocated as Zone 6 (Approx. 25.23 acres)

Exhibit Map

Proposed Allocation Change Union County, Tennessee XNR-159PT and XNR-160PT Powell River Mile 30.7L

Map Reference:
C/D Stage: 103
Quad: 145SE



Norris Reservoir

July 12, 2022

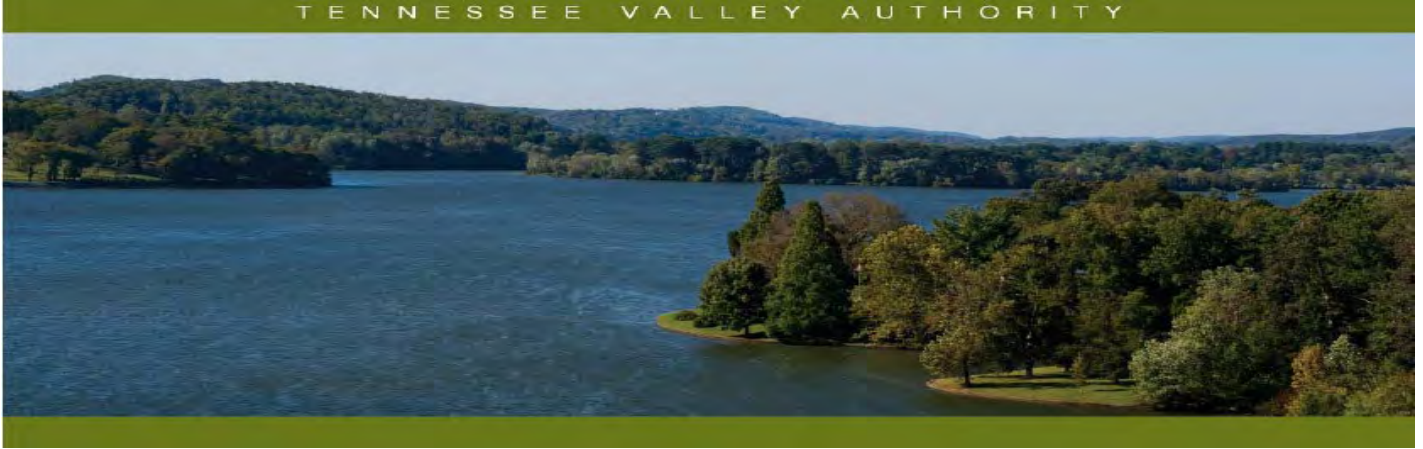

Norris Reservoir Land Management Plan Error – XNR-180PT (XNR-180aPT)

Reservoir Land Planning Errors

After approval of a reservoir land management plan (RLMP) by the Tennessee Valley Authority (TVA), future uses of TVA-managed lands on that reservoir must then be consistent with the land use allocations within that RLMP. Certain TVA reservoir land tracts have land management zones based on the backlying land use. These zone allocations have the potential to conflict with ingress and egress rights of the adjacent property owners if the backlying land use were to change. The resolution of these potential conflicts has resulted in the reallocation of the TVA-managed land to align with the ingress and egress rights of the adjacent property owners. This document addresses the reallocation of a portion of Norris Plan Tract No. XNR-180PT (XNR-180aPT) and is considered a supplement to the 2001 Norris RLMP. Definitions of TVA's land planning allocation zones are available at <https://www.tva.com/landplanzones>.

General Information about Norris Reservoir

Norris Reservoir is an impoundment of the Clinch River formed by Norris Dam, which is located at Clinch River mile 79.8. Norris Reservoir is situated in Anderson, Campbell, Union, Claiborne, and Grainger counties in east Tennessee. TVA originally acquired 122,000 acres of land for construction of the reservoir, which was completed in 1936. TVA has retained 27,927 acres of reservoir shore land lying above full pool elevation. At full pool, the reservoir is 129 miles long; mainland shoreline length is 809 miles; and reservoir surface area is 34,200 acres.

Norris Parcel 180 (XNR-180PT) and Parcel 180a (XNR-180aPT)

XNR-180PT (9.8 acres) is located in Union County, Tennessee along the right bank at Clinch River mile 118.2. In the 2001 Norris RLMP, XNR-180PT is allocated for Zone 3 (Sensitive Resource Management). However, a portion of XNR-180PT fronts a tract of former TVA land, XNR-333, which TVA sold subject to Section 31 of the TVA Act of 1933. In the deed (XNR-333), TVA granted the owners the right of ingress to and egress from Norris Lake. In order to resolve the potential conflict from the 2001 RLMP allocation of "Sensitive Resource Management" which does not allow for private water use facilities, a 2.89-acre portion of XNR-180PT was changed to "Residential Access" and designated as Parcel 180a (XNR-180aPT). XNR-180PT now consists of 6.91 acres and remains allocated as "Sensitive Resource Management."

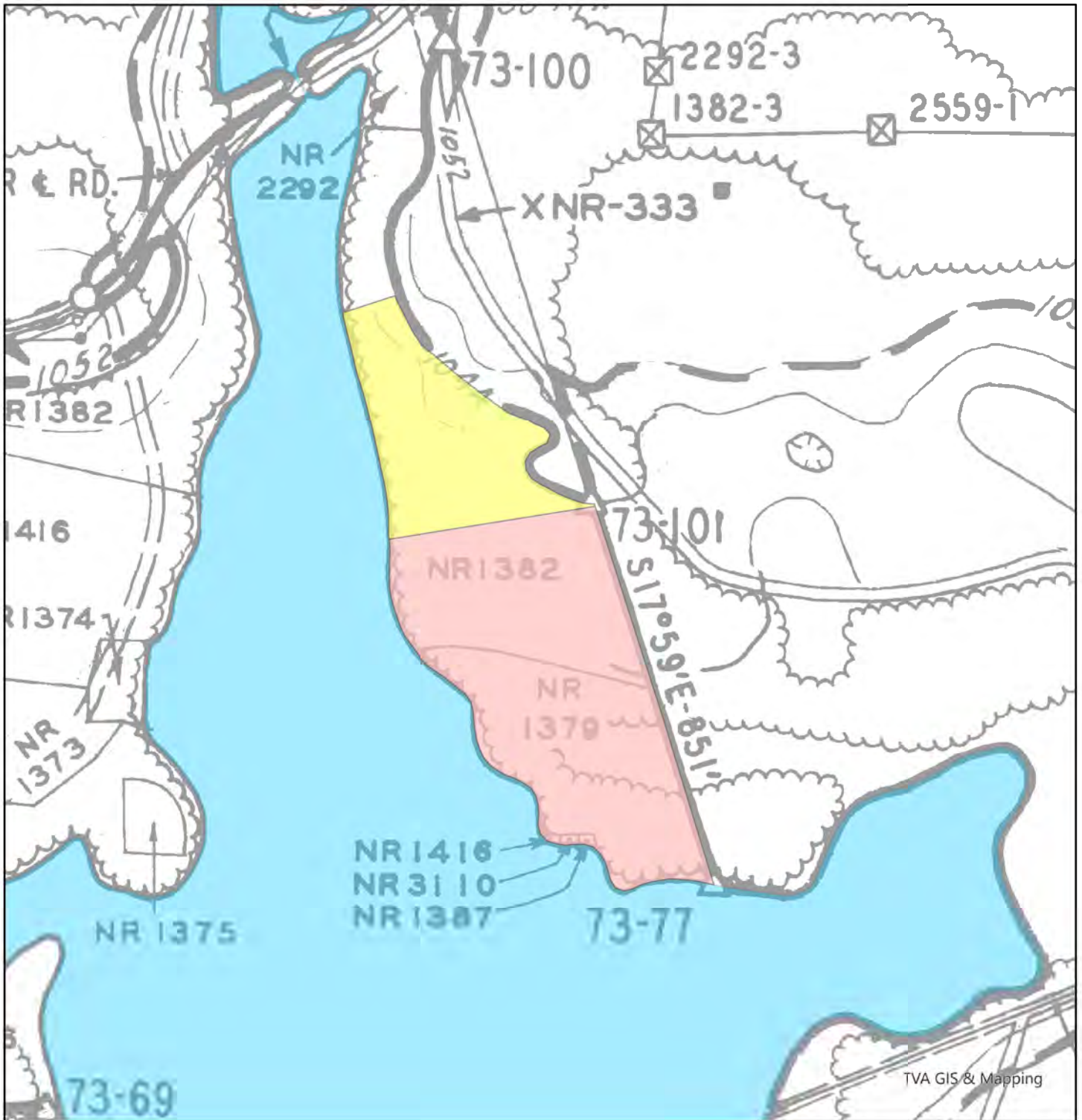

 Tract no. XNR-180aPT - Area To Reallocate to Zone 7 (Approx. 2.89 acre)

 Tract no. XNR-180PT - Area To Remain Allocated as Zone 3 (Approx. 6.91 acres)

Exhibit Map

Proposed Allocation Change
 Union County, Tennessee
 XNR-180PT
 Clinch River Mile 118.2R

Map Reference:
 C/D Stage: 73
 Quad: 145SE

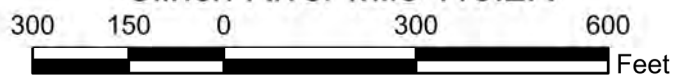

Norris Reservoir

July 7, 2022

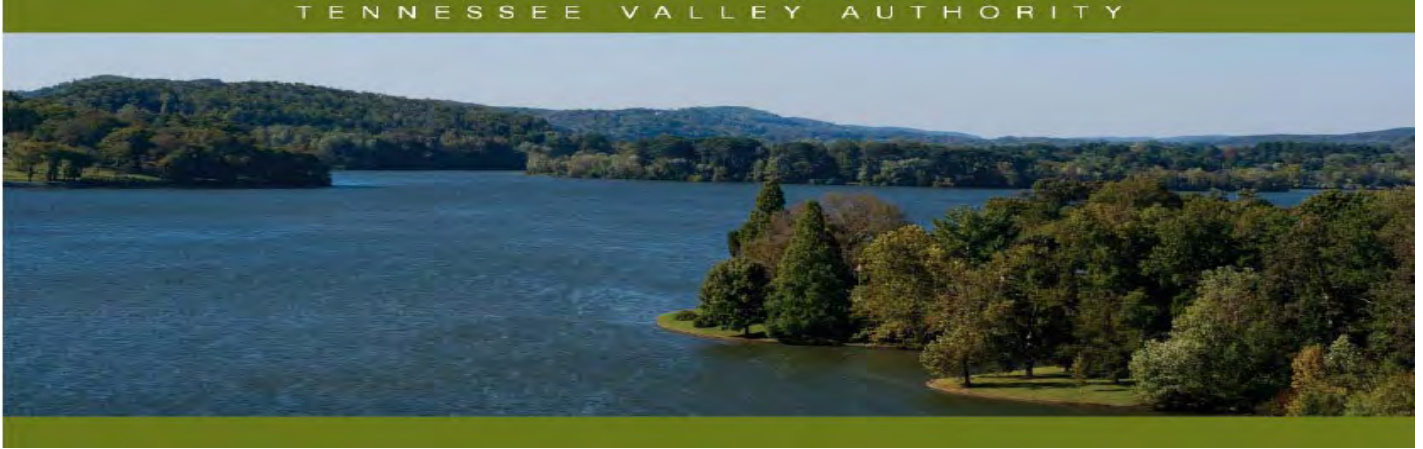

Norris Reservoir Land Management Plan Error – XNR-194PT and XNR-194aPT

Reservoir Land Planning Errors

After approval of a reservoir land management plan (RLMP) by the Tennessee Valley Authority (TVA), future uses of TVA-managed lands on that reservoir must then be consistent with the land use allocations within that RLMP. Certain TVA reservoir land tracts have land management zone based on the backlying land use. These zone allocations have the potential to conflict with ingress and egress rights of the adjacent property owners if the backlying land use were to change. The resolution of these potential conflicts has resulted in the reallocation of the TVA-managed land to align with the ingress and egress rights of the adjacent property owners. This document addresses the reallocation of a portion of Norris Plan Tract No. XNR-194PT (XNR-194aPT) and is considered a supplement to the 2001 Norris RLMP. Definitions of TVA's land planning allocation zones are available at <https://www.tva.com/landplanzones>.

General Information about Norris Reservoir

Norris Reservoir is an impoundment of the Clinch River formed by Norris Dam, which is located at Clinch River mile 79.8. Norris Reservoir is situated in Anderson, Campbell, Union, Claiborne, and Grainger counties in east Tennessee. TVA originally acquired 122,000 acres of land for construction of the reservoir, which was completed in 1936. TVA has retained 27,927 acres of reservoir shore land lying above full pool elevation. At full pool, the reservoir is 129 miles long; mainland shoreline length is 809 miles; and reservoir surface area is 34,200 acres.

Norris Parcel 194 (XNR-194PT) and Parcel 194a (XNR-194aPT)

XNR-194PT (282.84 acres) is located in Claiborne County, Tennessee along the right bank at Clinch River mile 125.1. In the 2001 Norris RLMP, XNR-194PT is allocated for Zone 4 (Natural Resource Conservation). However, a portion of XNR-194PT is encumbered by a license for a commercial marina. In order to resolve the potential conflicts from the 2001 RLMP allocation, the 3.0 acre portion was changed to "Developed Recreation" in order to recognize the agreement that was in existence at the time of the lands plan but was overlooked. The remainder of XNR-194PT (279.84 acres) continues to be allocated as "Natural Resource Conservation."

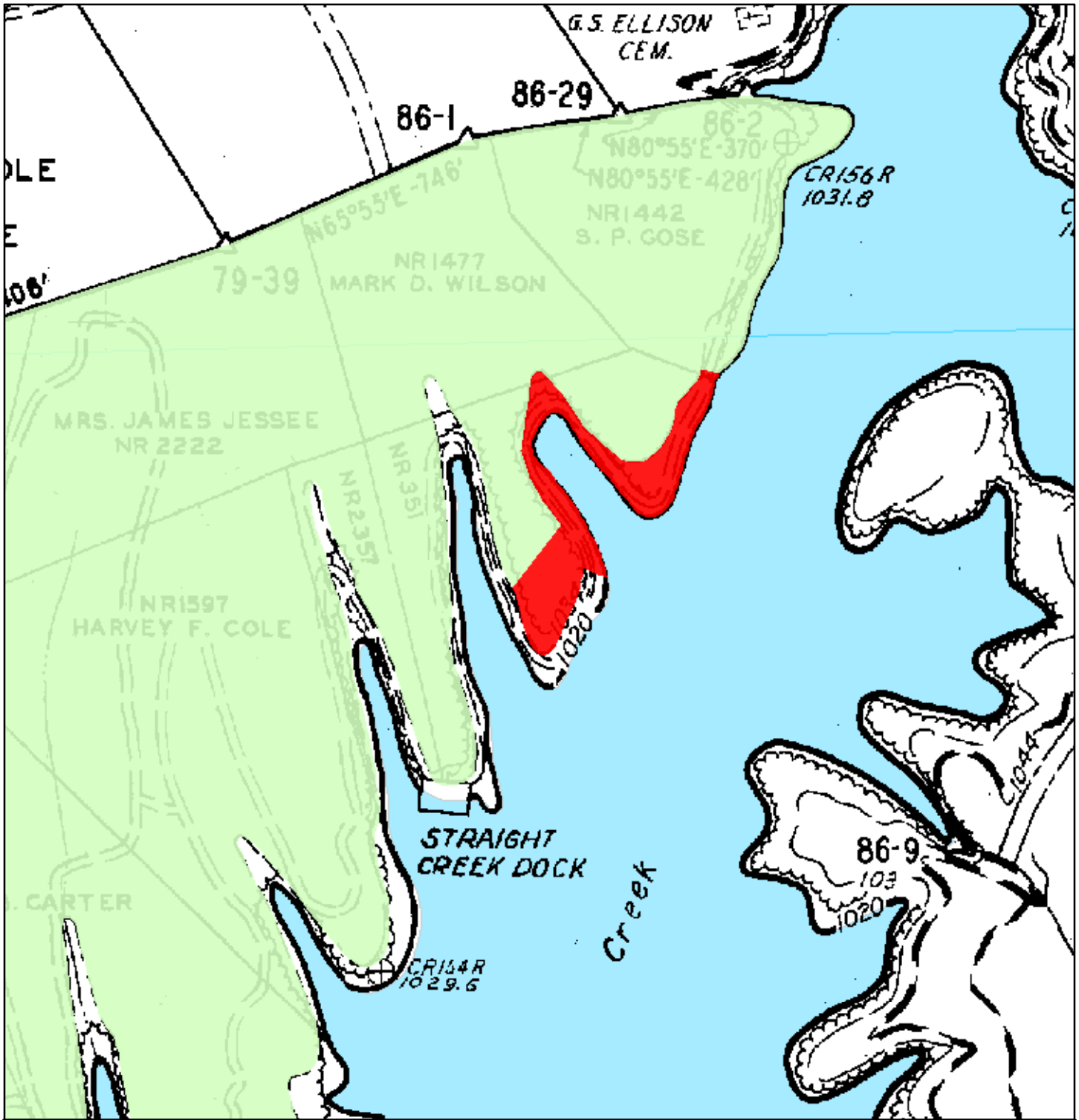

XNR-194aPT- Area to Reallocate to Zone 6 (Approx. 3.0 acre)



XNR-194PT - Area to Remain Allocated As Zone 4 (Approx. 279.84 acres)

Attachment 2- Exhibit

Proposed Allocation Change Claiborne County, Tennessee XNR-194PT Clinch River Mile 125.1R

Map Reference:
Dstage: 86
Quad: 154SW, 154NW



Norris Reservoir

April 5, 2021

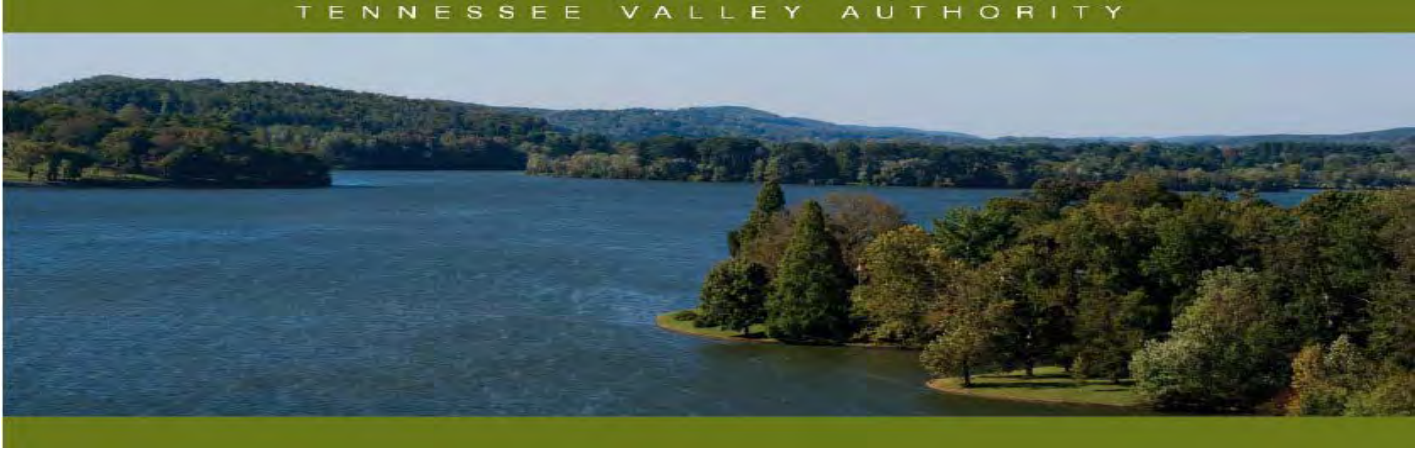

Norris Reservoir Land Management Plan Allocation Change – XNR-209PT and XNR-209aPT

Reservoir Land Planning Errors

After approval of a reservoir land management plan (RLMP) by the Tennessee Valley Authority (TVA), future uses of TVA-managed lands on that reservoir must then be consistent with the land use allocations within that RLMP. Recent research of deeds shows that on certain TVA reservoir land tracts and the current land use allocations have the potential to conflict with ingress and egress rights of the adjacent property owners if the backlying land use were to change. The resolution of these potential conflicts involves the reallocation of certain TVA-managed land to align with deeded ingress and egress rights across TVA shoreline property of the backlying property owners. This document addresses the reallocation of a portion of Norris Plan Tract No. XNR-209PT (XNR-209aPT) and is considered a supplement to the 2001 Norris RLMP. Definitions of TVA's land planning allocation zones are available at www.tva.gov/landplanzones.

General Information about Norris Reservoir

Norris Reservoir is an impoundment of the Clinch River formed by Norris Dam, which is located at Clinch River mile 79.8. Norris Reservoir is situated in Anderson, Campbell, Claiborne, Grainger, and Union counties in east Tennessee. TVA originally acquired 122,000 acres of land for construction of the reservoir, which was completed in 1936. TVA has retained 27,927 acres of reservoir shore land lying above full pool elevation. At full pool, the reservoir is 129 miles long; mainland shoreline length is 809 miles; and reservoir surface area is 34,200 acres.

Norris Parcel 209 (XNR-209PT) and Parcel 209a (XNR-209aPT)

XNR-209PT (65.4 acres) is located in Claiborne County along the right descending bank of Ball Creek mile 2.0 on Norris Reservoir. In the 2001 Norris RLMP, XNR-209PT was allocated as Zone 6 (Developed Recreation). However, XNR-209PT fronts a tract of former TVA land, XNR-755, which TVA sold subject to Section 31 of the TVA Act. Upon the sale of this land, TVA granted the "right of ingress to and egress from the waters of Norris Lake over and upon the adjoining land lying between the 1044-foot contour elevation and the waters of the lake." In order to resolve the potential land use conflict with the allocation of "Developed Recreation", which does not allow for private water use facilities, a 7.0-acre portion of the 65.4-acre parcel will be modified as XNR-209aPT (see Exhibit Map) and the land use allocation would change from "Developed Recreation" to Zone 7 (Shoreline Access). XNR-209aPT has approximately 1,820 linear feet of shoreline and allocation to "Shoreline Access" reflects the deeded access rights of ingress and egress across TVA shoreline property of the backlying property owner. Requests for private water use facilities would be considered on XNR-209aPT. XNR-209PT consists of the remainder of the original reservoir land tract (58.4 acres) and would continue to be allocated as "Developed Recreation."

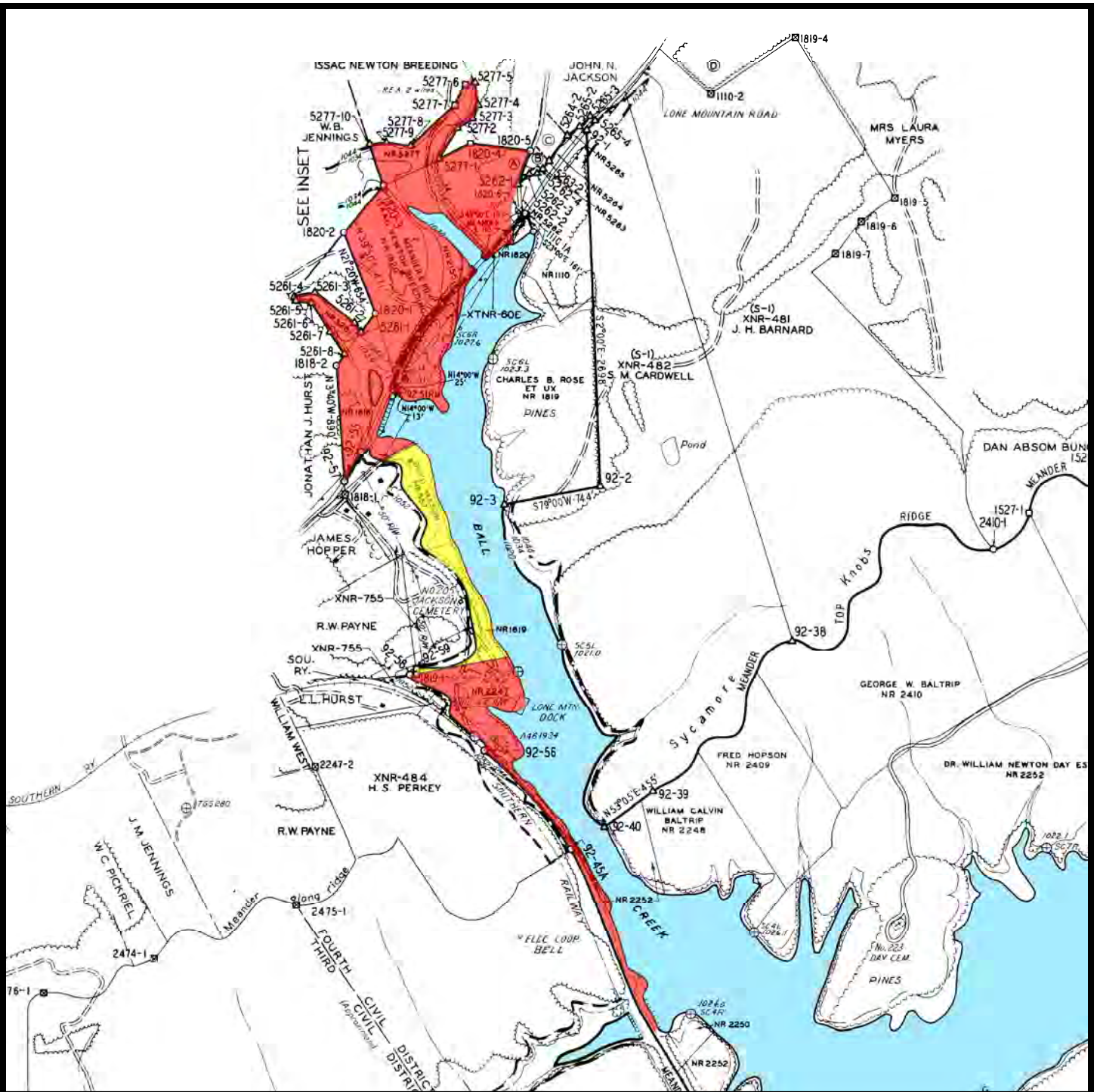

Exhibit Map

Land Use Allocation Change XNR-209PT and XNR-209aPT Claiborne County, Tennessee Ball Creek Mile 2.0R

- XNR-209PT - Area to Remain Zone 6 (Approx. 58.4 acres)
- XNR-209aPT - Area Reallocated to Zone 7 (Approx. 7.0 acres)

Map Reference:
C/D Stage: 92D
Quad: 154NE



Natural Resources



Norris Reservoir

March 10, 2017



Norris Reservoir Land Management Plan Allocation Change – XNR-272PT and XNR-272aPT

Reservoir Land Planning Errors

After approval of a reservoir land management plan (RLMP) by the Tennessee Valley Authority (TVA), all future uses of TVA-managed lands on that reservoir must then be consistent with the allocations within that RLMP. Certain TVA reservoir land tracts have land management zone allocations based on the backlying land use. These zone allocations have the potential to conflict with egress and ingress rights of the adjacent property owners if the backlying land use were to change. The resolution of these potential conflicts has resulted in the reallocation of the TVA-managed land to align with the egress and ingress rights of the adjacent property owners. This document addresses the reallocation of a portion of Norris Plan Tract No. XNR-272PT (Parcel 272) and is considered a supplement to the 2001 Norris RLMP. Definitions of TVA's land use allocations are available at www.tva.gov/landplanzones.

General Information about Norris Reservoir

Norris Reservoir is an impoundment of the Clinch River formed by Norris Dam, which is located at Clinch River Mile (CRM) 79.8. Norris Reservoir is located in the Tennessee counties of Anderson, Campbell, Claiborne, Grainger, and Union. TVA originally acquired 122,000 acres of land for construction of the reservoir, which was completed in 1936. TVA has retained 27,927 acres of land lying above full pool elevation. At full pool, the reservoir is 129 miles long; mainland shoreline length is 809 miles; and surface area is 34,200 acres.

Norris Parcel 272 (XNR-272PT) and Parcel 272a (XNR-272aPT)

XNR-272PT (13.48 acres) is located in Union County, Tennessee, along the left descending bank of Dodson Creek at CRM 120.8. In the 2001 Norris RLMP, XNR-272PT was allocated as Zone 4 (Natural Resource Conservation). However, a portion of XNR-272PT fronts a parcel of former TVA land, XNR-734, which TVA sold with the "right of ingress and egress over the adjoining land to the waters of the lake" and is now used for residential purposes. These access rights in the deed combined with the residential land use warrant an allocation change to reflect shoreline access rights. The "Natural Resource Conservation" allocation does not allow for private water use facilities, so in order to resolve the potential conflict of the "Natural Resource Conservation" allocation in the 2001 RLMP, approximately 10.04 acres of XNR-272PT with 262 feet of shoreline is renamed as XNR-272aPT (Parcel 272a) and is reallocated as Zone 7 (Shoreline Access); requests for private water use facilities will be considered on Parcel 272a. The remainder of XNR-272PT (3.44 acres) remains allocated as "Natural Resource Conservation."

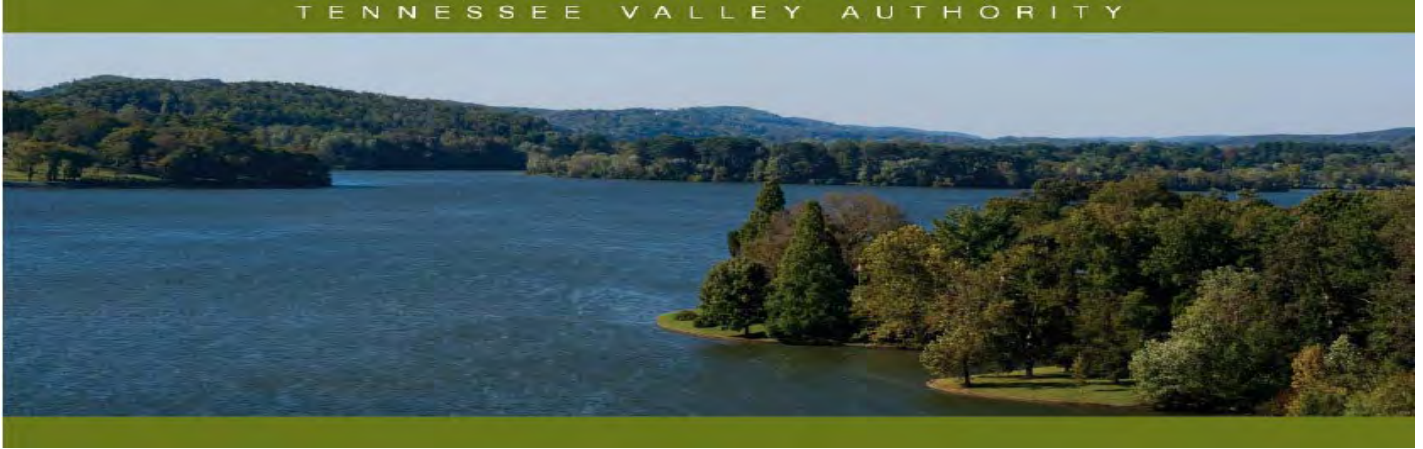

Norris Reservoir Land Management Plan Allocation Change – XNR-310aPT and XNR-310bPT

Reservoir Land Planning Errors

After approval of a reservoir land management plan (RLMP) by the Tennessee Valley Authority (TVA), future uses of TVA-managed lands on that reservoir must then be consistent with the land use allocations within that RLMP. Certain TVA reservoir land tracts have land management zone allocations based on the backlying land use. These zone allocations have the potential to conflict with egress and ingress rights of the adjacent property owners if the backlying land use were to change. The resolution of these potential conflicts has resulted in the reallocation of the TVA-managed land to align with the ingress and egress rights of the adjacent property owners. This document addresses the reallocation of a portion of Norris Plan originally allocated as Zone 1 (Non-TVA Shoreland) and is considered a supplement to the 2001 Norris RLMP. Definitions of TVA's land planning allocation zones are available at <https://www.tva.com/landplanzones>.

General Information about Norris Reservoir

Norris Reservoir is an impoundment of the Clinch River formed by Norris Dam, which is located at Clinch River mile 79.8. Norris Reservoir is situated in Anderson, Campbell, Union, Claiborne, and Grainger counties in east Tennessee. TVA originally acquired 122,000 acres of land for construction of the reservoir, which was completed in 1936. TVA has retained 27,927 acres of reservoir shore land lying above full pool elevation. At full pool, the reservoir is 129 miles long; mainland shoreline length is 809 miles; and reservoir surface area is 34,200 acres.

Norris Parcel 310a and Parcel 310b

Norris shoreland adjacent to TVA sale tract XNR-15 was allocated for Zone 1 (Non-TVA Shoreland) in the 2001 Norris RLMP. XNR-15 was sold at auction by TVA in 1953 as individual lots of Pellissippi Point Subdivision. Although most lots in Pellissippi Point Subdivision were sold to the 1020-foot contour (i.e., the shoreline of Norris Reservoir), some lots were sold to the 1034-foot contour. All lots have the necessary rights of ingress and egress for the ability to request water-use facilities, but there is a strip of TVA land fronting a small number of lots. In order to rectify this error and to ensure public awareness of the TVA land in these locations to prevent violations and encroachments, TVA has reallocated lands from Zone 1 to Zone 7 (Shoreline Access) where fronting residential areas and from Zone 1 to Zone 6 (Developed Recreation) where fronting commercial recreation areas. Therefore, a 3.1-acre area (TVA Tract No. XNR-310aPT) has been reallocated from Zone 1 to Zone 7 (Shoreline Access) and a 0.13-acre area (TVA Tract No. XNR-310bPT) has been reallocated from Zone 1 to Zone 6 (Developed Recreation). The remainder of the area fronting the XNR-15 sale tract is still allocated as Zone 1 (Non-TVA Shoreland). Requests for private water-use facilities can be considered fronting the Zone 1 and Zone 7 allocations. Requests supporting recreational use (commercial or public) can be considered fronting the Zone 6 allocation.

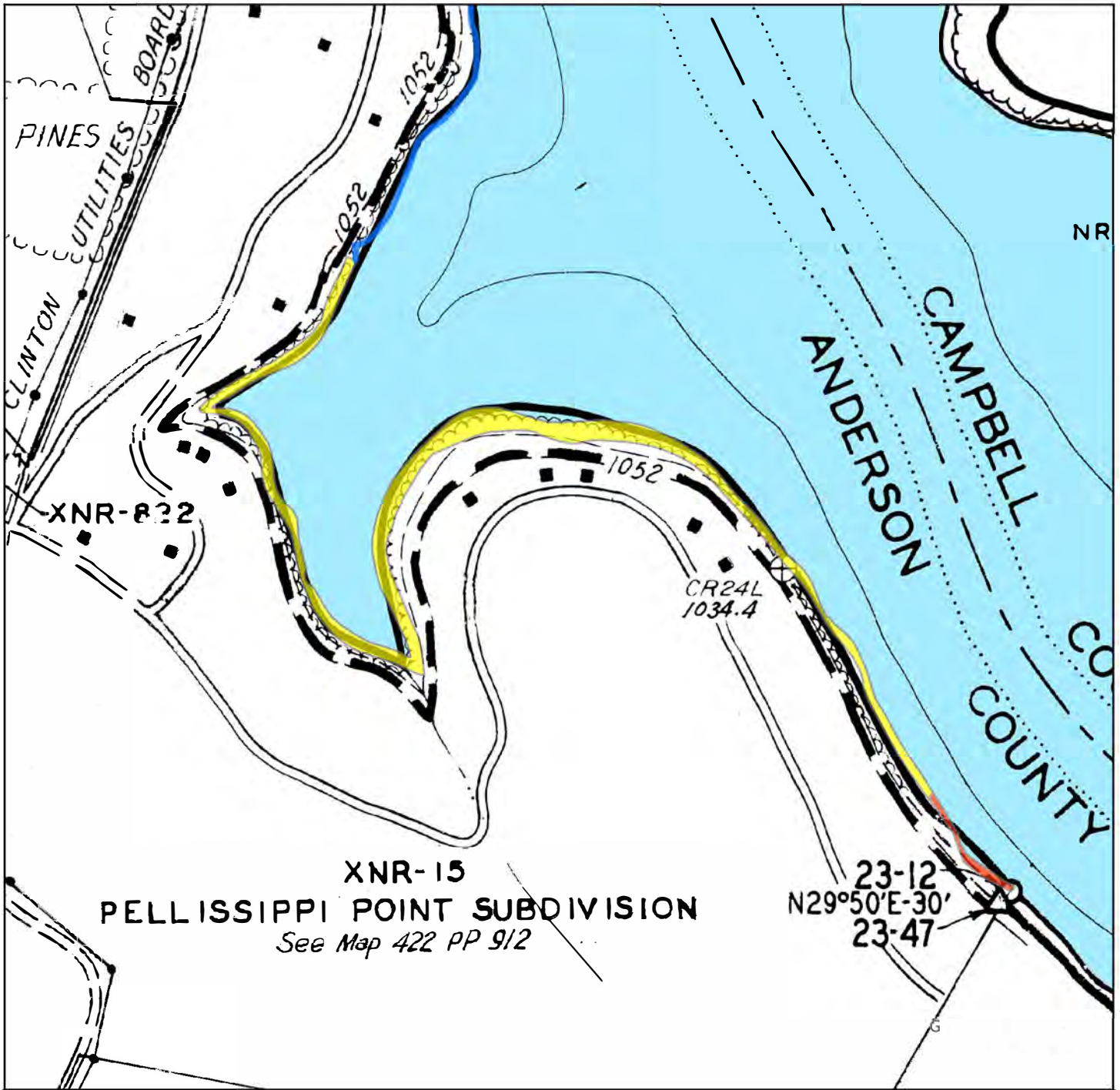





Exhibit Map

Map Reference:
C/D Stage: 23, 27
Quad: 136SE

-  Zone 1 - Shoreline
Allocation to Remain
-  XNR-310aPT - Area to be
Reallocated to Zone 7
(Approx. 3.1 acres)
-  XNR-310bPT - Area to be
Reallocated to Zone 6
(Approx. 0.13 acre)

Proposed Allocation Change Anderson County, Tennessee XNR-310PT Clinch River mile 90.5L



Natural Resources

Norris Reservoir



May 18, 2025

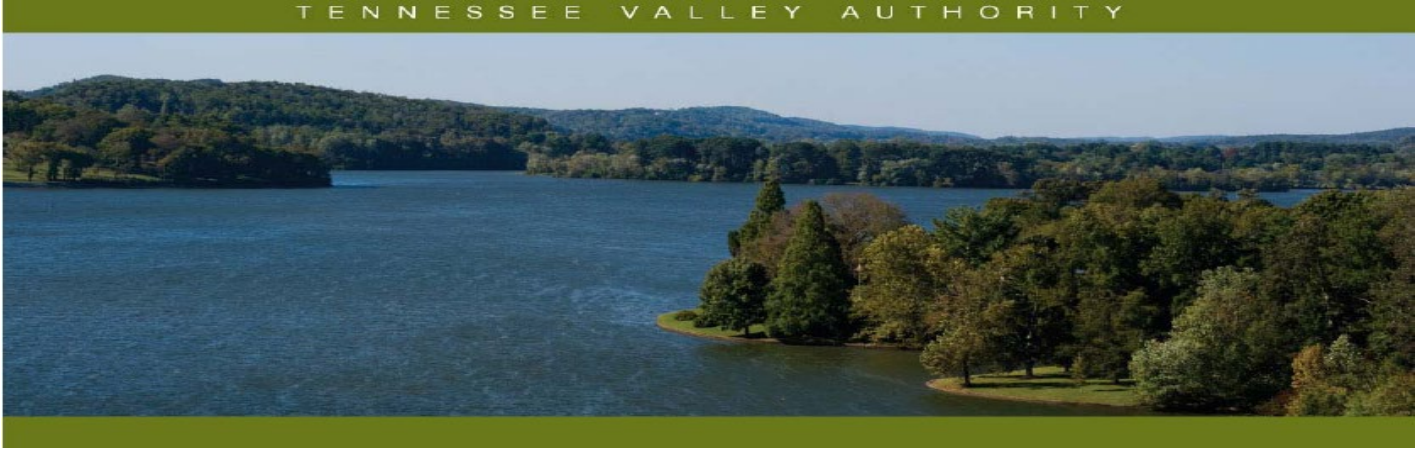

Norris Reservoir Land Management Plan Allocation Change – XNR-310PT (XNR-310cPT)

Reservoir Land Planning Errors

After approval of a reservoir land management plan (RLMP) by the Tennessee Valley Authority (TVA), future uses of TVA-managed lands on that reservoir must then be consistent with the land use allocations within that RLMP. Certain TVA reservoir land tracts have land management zone allocations based on the backlying land use. These zone allocations have the potential to conflict with access rights which qualify the adjacent property owners for consideration to receive a permit for a private dock or water use facility if the backlying land use were to change. The resolution of these potential conflicts has resulted in the reallocation of the TVA-managed land to align with the implied rights of egress and ingress of the adjacent property owners. This document addresses the reallocation of a portion of Norris Plan Tract No. XNR-310PT (XNR-310cPT) and is considered a supplement to the 2001 Norris RLMP. Definitions of TVA's land planning allocation zones are available at <https://www.tva.com/landplanzones>.

General Information about Norris Reservoir

Norris Reservoir is an impoundment of the Clinch River formed by Norris Dam, which is located at Clinch River mile 79.8. Norris Reservoir is situated in Anderson, Campbell, Union, Claiborne, and Grainger counties in east Tennessee. TVA originally acquired 122,000 acres of land for construction of the reservoir, which was completed in 1936. TVA has retained 27,927 acres of reservoir shore land lying above full pool elevation. At full pool, the reservoir is 129 miles long; mainland shoreline length is 809 miles; and reservoir surface area is 34,200 acres.

Norris Parcel 310 (XNR-310PT), Parcel 310c (XNR-310cPT)

XNR-310PT (24.15 acres) is located in Anderson County, Tennessee along the left bank at Clinch River mile 91.3. In the 2001 Norris RLMP, XNR-310PT is allocated for Zone 6 (Developed Recreation). However, a portion of XNR-310PT fronts a tract of former TVA land, XNR-604, which TVA sold subject to Section 31 of the TVA Act of 1933. In the deed, TVA granted the owners the right of ingress and egress to and from the waters of Norris Lake, these implied rights qualify the owners to be eligible for consideration to receive a permit for the purpose of constructing and maintaining water use facilities. A 1.03-acre portion of this land is not associated with a commercial recreation area and there are associated residential Section 26a applications. In order to resolve the potential conflicts from the 2001 RLMP allocations which do not allow for private water use facilities, a 1.03-acre portion of XNR-310PT was reallocated to "Residential Access" and designated as Parcel 310c (XNR-310cPT). XNR-310cPT now consists of 23.12 acres and remains allocated as "Developed Recreation."

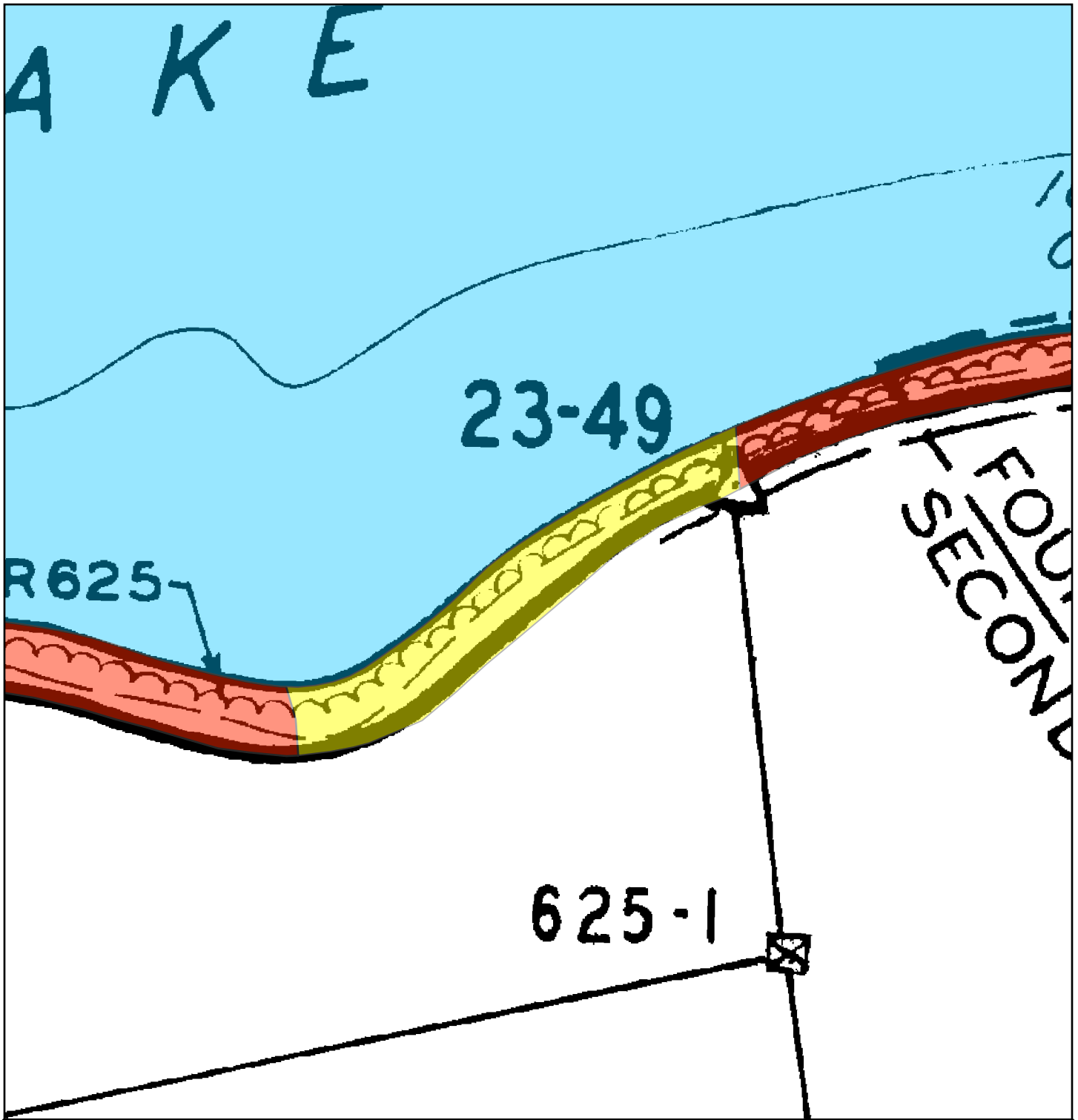







Exhibit Map
Proposed Allocation Change
Anderson County, Tennessee
XNR-310PT
Clinch River Mile 91.3L

Map Reference:
 C/D Stage: 23
 Quad: 136SE

 XNR-310cPT -Area to be Reallocated to Zone 7 (Approx. 1.03 acres)
 XNR-310PT- Area to be Remain to Zone 6 (Approx. 23.12 acres)

 
 Public Land Management

200 0 200
 Feet
 October 1, 2025

Norris Reservoir

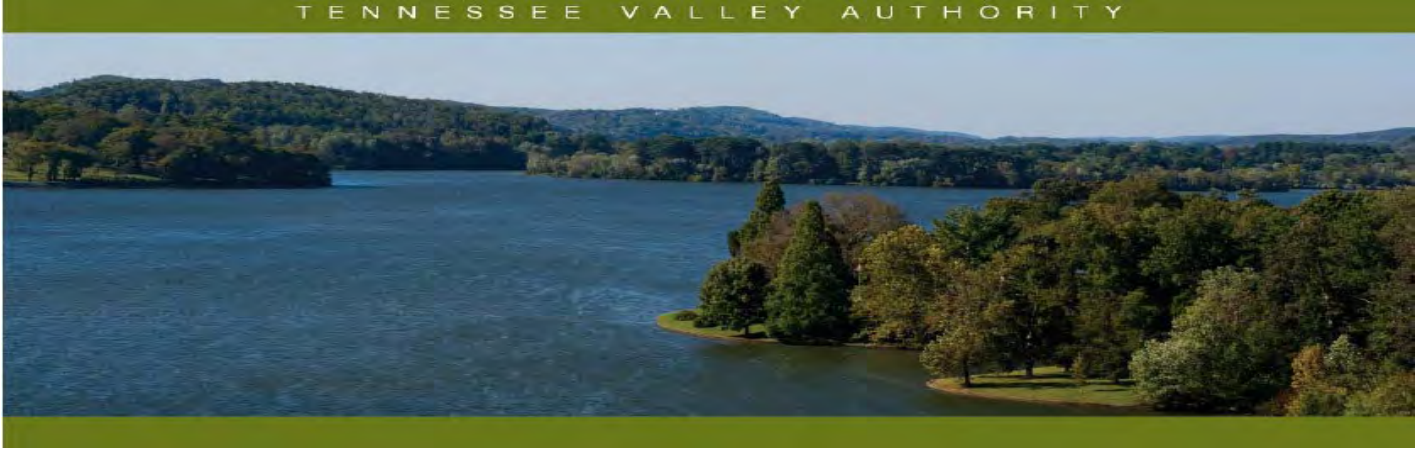

Norris Reservoir Land Management Plan Allocation Change – XNR-313PT and XNR-313aPT

Reservoir Land Planning Allocation Changes

After approval of a reservoir land management plan (RLMP) by the Tennessee Valley Authority (TVA), future uses of TVA-managed lands on that reservoir must then be consistent with the land use allocations within that RLMP. Pursuant to TVA's Land Policy, TVA shall consider changing a land use designation outside of the normal planning process only for water access purposes for industrial or commercial recreation operations on privately owned backlying land. This document addresses the reallocation of a portion of Norris Plan Tract No. XNR-313PT (XNR-313aPT) and is considered a supplement to the 2001 Norris RLMP. Definitions of TVA's land planning allocation zones are available at <https://www.tva.com/landplanzones>.

General Information about Norris Reservoir

Norris Reservoir is an impoundment of the Clinch River formed by Norris Dam, which is located at Clinch River mile 79.8. Norris Reservoir is situated in Anderson, Campbell, Union, Claiborne, and Grainger counties in east Tennessee. TVA originally acquired 122,000 acres of land for construction of the reservoir, which was completed in 1936. TVA has retained 27,927 acres of reservoir shore land lying above full pool elevation. At full pool, the reservoir is 129 miles long; mainland shoreline length is 809 miles; and reservoir surface area is 34,200 acres.

Norris Parcel 313 (XNR-313PT) and Parcel 313a (XNR-313aPT)

XNR-313PT (68.01 acres) is located in Anderson County, Tennessee along the right bank at Clinch River mile 83.8L. In the 2001 Norris RLMP, XNR-313PT is allocated for Zone 7 (Residential Access). However, the private backlying property owner has requested Section 26a approval and an easement for a commercial recreation water-use facility on the TVA land fronting a portion of this property. The "Residential Access" land use allocation is considered incompatible with the request as proposed by the commercial operator. To allow consideration of the request and in accordance with the TVA Land Policy, TVA reallocated a 0.49-acre portion of the property, Tract No. XNR-313aPT, for "Developed Recreation." The remainder of XNR-313PT (67.52 acres) continues to be allocated as "Residential Access."

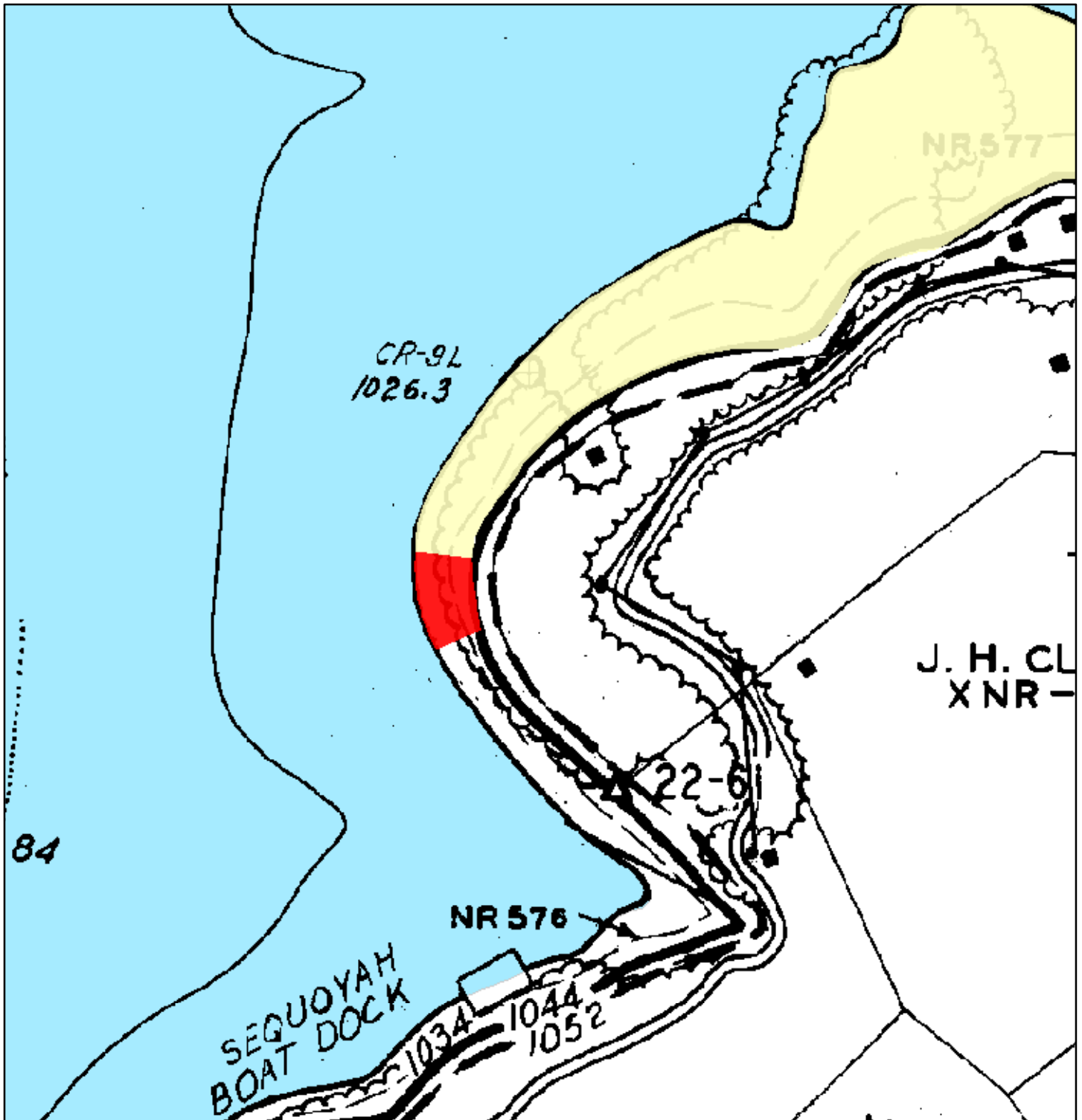

 XNR-313aPT - Area To Reallocate to Zone 6 (Approx. 0.49 acre)

 XNR-313PT - Area to Remain Allocated as Zone 4 (Approx. 67.52 acres)

Exhibit Map
Proposed Allocation Change
Anderson County, Tennessee
XNR-313PT
Clinch River Mile 83.8L

Map Reference:
 Dstage: 22
 Quad: 136SE



Norris Reservoir

September 8, 2023

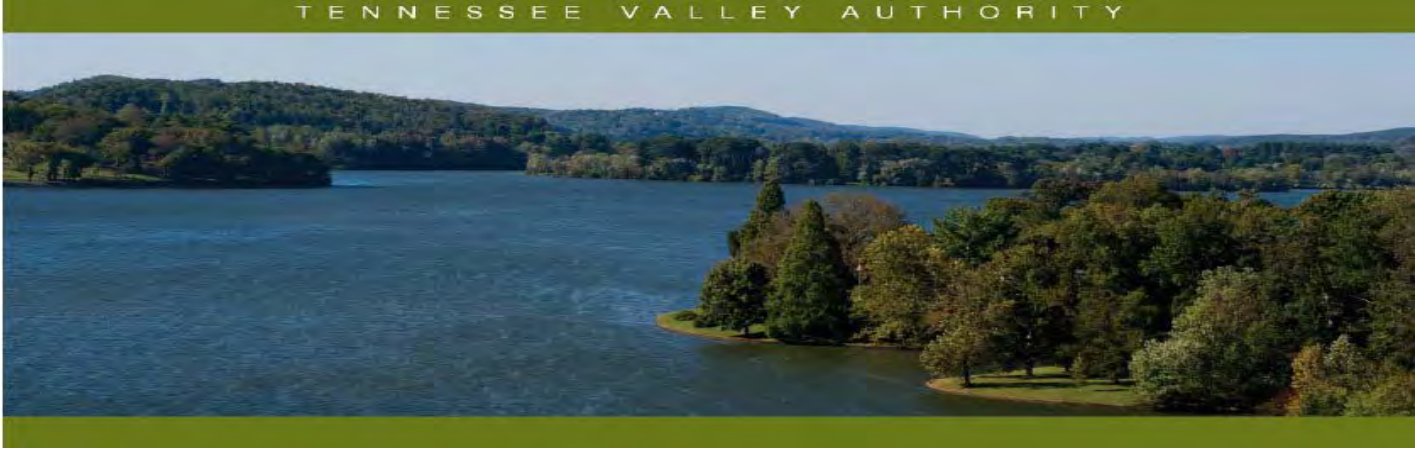

Norris Reservoir Land Management Plan Allocation Change – XNR-315PT and XNR-315aPT

Reservoir Land Planning Errors

After approval of a reservoir land management plan (RLMP) by the Tennessee Valley Authority (TVA), future uses of TVA-managed lands on that reservoir must then be consistent with the land use allocations within that RLMP. Certain TVA reservoir land tracts have land management zone based on the backlying land use. These zone allocations have the potential to conflict with ingress and egress rights of the adjacent property owners if the backlying land use were to change. The resolution of these potential conflicts has resulted in the reallocation of the TVA-managed land to align with the ingress and egress rights of the adjacent property owners. This document addresses the reallocation of a portion of Norris Plan Tract No. XNR-315PT (new XNR-315aPT) and is considered a supplement to the 2001 Norris RLMP. Definitions of TVA's land planning allocation zones are available at www.tva.gov/landplanzones.

General Information about Norris Reservoir

Norris Reservoir is an impoundment of the Clinch River formed by Norris Dam, which is located at Clinch River mile 79.8. Norris Reservoir is situated in Anderson, Campbell, Claiborne, Grainger and Union counties in east Tennessee. TVA originally acquired 122,000 acres of land for construction of the reservoir, which was completed in 1936. TVA has retained 27,927 acres of reservoir shore land lying above full pool elevation. At full pool, the reservoir is 129 miles long; mainland shoreline length is 809 miles; and reservoir surface area is 34,200 acres.

Norris Parcel 315 (XNR-315PT) and Parcel 315a (XNR-315aPT)

XNR-315PT (5.3 acres) is located in Anderson County along the left descending bank of Clinch River mile 84.0 on Norris Reservoir. In the 2001 Norris RLMP, XNR-315PT was allocated as Zone 6 (Developed Recreation) for an existing commercial marina and resort. However, a portion of XNR-315PT fronts a tract of former TVA property, XNR-803, which TVA sold subject to Section 31 of the TVA Act. In the deed, TVA granted the owners the right of ingress and egress rights to and from the waters of Norris Lake over and upon the adjoining land lying between the 1044-foot contour elevation and the waters of the lake, and the deed does not contain any restrictions otherwise limiting those rights. In order to resolve the potential land use conflict with the allocation of "Developed Recreation", which does not allow for private water use facilities, a 0.5-acre portion of the 5.3-acre parcel will be modified as XNR-315aPT (see Exhibit Map) and the land use allocation changes from "Developed Recreation" to Zone 7 (Shoreline Access). The new 0.5-acre parcel (renamed XNR-315aPT) has approximately 186 linear feet of shoreline and the "Shoreline Access" allocation reflects the deeded access rights of ingress and egress across TVA shoreline property of the backlying property owners. Requests for private water use facilities would be considered on XNR-315aPT. The remainder of XNR-315PT remains allocated as "Developed Recreation."

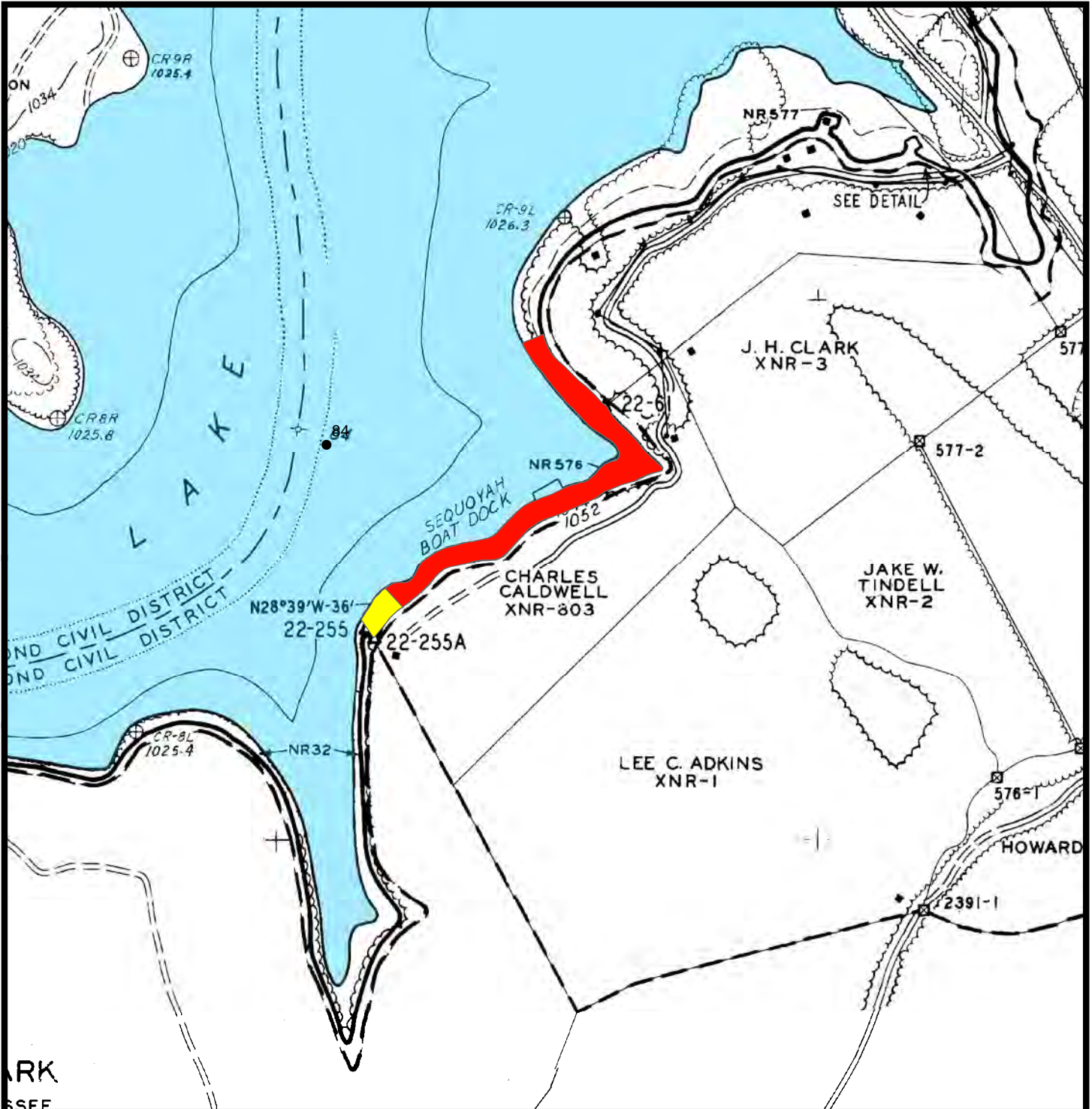

Exhibit Map

Land Use Allocation Change XNR-315PT and XNR-315aPT Anderson County, Tennessee Clinch River Mile 84.0L

Map Reference:
D-Stage: 22
Quad: 137NE



Natural Resources

- XNR-315PT - Area To Remain as Zone 6 (Approx. 4.8 acres)
- XNR-315aPT - Area Reallocated to Zone 7 (Approx. 0.5 acre)

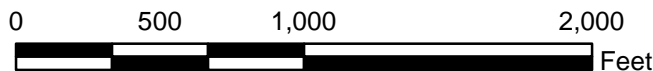

Norris Reservoir

April 30, 2018